

Nordhavn 55 Terrapin



JEFF MERRILL
YACHT SALES, INC.

3010 Old Ranch Pkwy, Suite 440, Seal Beach, CA 90740
+1 949.355.4950 | www.JMYS.com

Florida address: 1550 S.E. 17th Street, Suite 3 | Fort Lauderdale, FL 33316



TERRAPIN

Asking: \$995,000.00 Location: Stuart, FL

Nordhavn 55 Terrapin

NAME: *Terrapin*
TYPE: Long range passage maker
DRAFT: Minimum 5'9" Maximum 6'6"
BUILDER: P.A.E./South Coast China
MODEL: NORDHAVN 55
COLOR: Green LP paint
DESIGNER: Jeff Leishman
HULL MATERIAL: Solid Fiberglass
YEAR: 2007
ENGINE: John Deere 6081 330 HP
ENGINE TRANSMISSION: ZF 4:1 reduction gear
RANGE: 2,761 @ 8.5 knots **SPEED:** Cruise 8.5, Top 10.0 knots
WING ENGINE: Lugger L984D 70 HP (30 hours)
BOW AND STERN THRUSTERS: Sidepower 24V electric 15HP
STABILIZERS: ABT TRAC 250 digital active fins with 9.5 sq. ft. fins
CRANE: Aritex 1500 lb.
WATERMAKER: Village Marine PW1200 (1,200 gallons / day)
CLIMATE CONTROL: Cruisair Air conditioning and Webasto diesel furnace
WINDLASS: Maxwell 3500 electric
INVERTER: Xantrex SW series
GENERATOR: Northern Lights 20 kW
(Generator hours: 3,495)

LOA: 61'0"
BEAM: 18'0"
LWL: 50'1"
D/L: 370 A/B: 2.47:1
TYPE: Raise pilothouse
BOTTOM PAINT: Black
DISPLACEMENT: 124,500 lbs.
BALLAST: 8,500 lbs.
EXHAUST: Dry stack, keel cooled
ENGINE HOURS: 2,775
FUEL: 2,350 gals.
HOLDING BLACK: 120 gals.
HOLDING GRAY: 120 gals.
FRESH WATER: 600 gals

INTRODUCTION:

Terrapin is an extraordinary Nordhavn 55 that has provided a safe and comfortable platform for the current owners to enjoy long range cruising. The current owners are experienced boaters (they circumnavigated on a Mason sailboat in the 80's and 90s). When they were shopping for a proper trawler they settled on the Nordhavn 55 as the ideal vessel, and were convinced once they got aboard and saw the unique white laminate bulkheads with teak trim that highlight the living areas in the master and guest staterooms and heads. *Terrapin* was painted in Port Townsend, WA shortly after purchase and has now actively travelled thousands of miles offshore starting in Washington, heading up to Canada and then down the US west coast with several stops before transiting the Panama Canal and crossing the Caribbean.

Terrapin features the popular three cabin layout (master, guest and captain) with three heads and a spacious saloon/galley area and outstanding pilothouse with flybridge above. For offshore cruising, she has the durable Deere main (dry stack exhaust) and for close quarter maneuvering she has bow and stern thrusters. *Terrapin* can travel for long distance passages and handle close quarter maneuvering with equal ease of handling.

The interior on *Terrapin* is light and airy due to the white laminate panels in the staterooms (the same white with teak trim that is standard on every 55 and 60 utility room. The varnished teak is a nice compliment and the cabins feel much larger due to this nice improvement that was installed when she was ordered new. The interior shows like new, the sellers are very meticulous in their care.

Nordhavn 55 Terrapin

With over (50) Nordhavn 55's launched, PAE retired this model to concentrate on the 60 and 63 (made from the same hull molds) so *Terrapin* represents an outstanding opportunity to buy an extremely well outfitted trawler with an asking price hundreds of thousands of dollars below the starting base price for a new build...and in addition to a huge savings, you don't have to wait - you can take off immediately!

She will eventually be re-located to Stuart, FL where she will be poised for a cruise north to Maine, or a venture south to the islands. Think of the possibilities, a proven Nordhavn 55 with extensive upgrades, cruise ready and tugging at her dock lines to move again. All you need to add is diesel, provisions and your sense of adventure!

The popularity of this magnificent cruising trawler is as impressive as *Terrapin* is to behold in person. The Nordhavn 55 design has already accomplished numerous Atlantic and Pacific crossings (sister ships) and there are Nordhavn 55's literally spread all over the world. The Nordhavn 55 model is an ideal platform for adventurous cruisers who seek the ultimate in an owner/operator long distance passage maker.

TERRAPIN – HULL NUMBER 26

The Nordhavn 55 design is a very large yacht. Measuring nearly 62' overall she is a robust yacht with a lot of headroom and a large freeboard balanced by appropriate ballast to keep her on an even keel while feet underway. Her systems engineering benefits from the hundreds of ocean crossing Nordhavns who preceded her. There is something to say about the advantages of buying a proven trawler that has already been out exploring - it provides confidence and peace of mind.

ACCOMMODATIONS & LAYOUT:

MAIN SALOON AND GALLEY:

You can board the Nordhavn 55 from the extended swim platform which leads to a centered cockpit door or from her covered starboard side deck. When you enter the saloon you will be impressed by the amount of space and luxurious appointments. The teak joinery is rich to behold and the soles are teak and spruce. You will appreciate her leisure comforts and upon close inspection see that the built in 40" flat screen television is installed to port in the saloon. This large saloon is great for relaxing and dining seated on comfortable cushions wrapped with ultra leather. There are two custom and comfortable chairs to starboard that add a warm, homey feel. The saloon features a large teak dinette table with starburst pattern and high gloss varnish surface to port with L-shaped settee (abundant storage beneath the seating).

The saloon transitions into an elegant galley that is a barely noticeable two steps down and features all of the essential galley appliances. There is excellent ventilation in the galley provided by an opening port light outboard. There are plenty of overhead and under counter lockers and drawers for storing everything you need in a proper seagoing galley. This is a working galley where two people can share the counter space and the teak and spruce floor along with lockers and drawers provides essential storage for the necessary provisioning and galley gear.

At the forward end of the saloon you ascend a flight of steps to arrive in the wheelhouse, or you can open a cabin door that leads to the master stateroom. Also off the galley is a stairway down that leads to the engine room via the utility room (which boasts a top load freezer and separate front loading clothes washer and clothes dryer).

MASTER STATEROOM:

Nordhavn 55 Terrapin

Entering the master by continuing forward from the galley makes for a single level layout that is one of the most appealing features of the 55 design (with both of the master stateroom doors open you have all of the living spaces essentially on one level). For privacy, the galley to master door can be closed and then other crew aboard would go up and down through the pilothouse stairs to reach the forward guest cabin. The island berth in the Master runs athwartship providing plenty of walking space, bed stand counters on both sides as well as two hanging lockers. There is an upholstered soft headboard. There are opening port lights outboard to port and the master stateroom, like the rest of the living spaces, is comfortably air-conditioned. A special opening hatch forward ducts to the Portuguese bridge walk way providing natural light and creating a protected air flow...a huge plus at anchor.

The master has an ensuite head to starboard, which includes a tub / shower outboard and forward. This head is ideal for the owners to refresh themselves. There are mirrors, drawers, a medicine locker and plenty of room for his and hers toiletries.

PILOTHOUSE:

The Nordhavn 55 wheelhouse is huge and the view is spectacular. There is an expansive navigation console with overhead panels and below window dash panels logically outfitted with all of the necessary control panels needed to operate *Terrapin*. The Stidd helm chair is the best perch for running this vessel underway. The windows and outboard Dutch Doors are all Diamond Sea/Glaze commercial strength. A large L-shaped bench seat fronted by a teak table makes this location the perfect place for “back seat” drivers and ideal for catching a bite to eat while enjoying the incredible panoramic view.

The helm dash features a large vertical 30” teak destroyer steering wheel. The main engine, wing engine and generator control panels are positioned for straight forward monitoring as are all of the other key systems display heads. There is a practical electric island that extends aft from the starboard side of the dash area and houses all of the DC and AC breakers plus the air conditioning select breakers and more. All of the ships electrical distribution panels are hinged for access to wiring.

Terrapin is maneuvered with the convenient installation of two outside docking stations -one on the Portuguese bridge starboard side and the other in the cockpit. These stations include the main engine shift and rpm, plus joy sticks for the bow and stern thrusters. There is an extensive collection of navigational electronics selected to include all necessities for long range coastal cruising and ocean passages.

Captains’ Cabin:

All the way aft along the port side of the wheelhouse is an isolated captain’s cabin, ideally situated as a third stateroom that includes a wide double bed and storage. This cabin is situated conveniently near the action while at the same time secluded in privacy. There are also blinds on the windows.

Pilothouse Day Head:

Aft to starboard is one of the best features of the 55, a pilothouse head with toilet and sink for use by the captain and/or on watch crew. It also serves as a convenient day head due to its’ close proximity to the saloon.

Fronting the pilothouse is a Portuguese bridge deck from which you can go up and aft to port to reach the boat deck and flybridge, or out to starboard for a quick forward turn to the foredeck or face aft to walk along the covered side deck on your way back to the cockpit.

Forward stairway:

Nordhavn 55 Terrapin

The wheelhouse has a nicely curved staircase forward that leads to the master and guest staterooms. This stairwell is beautifully varnished cherry with a stainless steel handrail. The stairwell includes lockers outboard to starboard.

GUEST STATEROOM:

All the way forward in the boat is a cleverly designed cabin with a centerline bulkhead that separates a double bed to port from an office desk and swivel chair to starboard. There are two doors forward to the head and shower. The stateroom has a centerline divider which includes a double sliding door for sleeping privacy to port and also boasts a swinging portion forward that, when pivoted forward to starboard, converts this entire area into one large suite. The bed to port will sleep two.

The forward head has an overhead hatch and two cabin doors. A granite counter with sink and a large medicine cabinet is located to starboard. A good sized shower and bi-fold door and a Tecma freshwater toilet are separated by a nice tile floor.

The Basement:

Beneath the guest stateroom is huge equipment and storage cellar, a “hidden” area that is accessed by a hinged floor hatch. You descend a sturdy ladder to find the bow thruster forward and all of the ship’s fresh water components including water heater, two fresh water pumps (24V and 110V), water maker and an extensive fresh water manifold system. This is a great storage area divided into four chambers. The forward bow chamber is the location for the bow thruster. Chamber two includes custom shelves for storing small containers and spares. The third/entrance chamber has conveniently positioned breakers for the windlass plus storage shelves. On *Terrapin*, this port outboard area has a proper work bench installed! The Village Marine water maker (1,200 gallons per day) is also installed here.

WORKING AREAS:

UTILITY ROOM:

Descending the curved stairway from the galley you arrive in the utility room. This is a forward antechamber for the engine room and includes a top load freezer and separate front-loading Bosch Axxis clothes washer and front-loading Bosch Axxis clothes dryer outboard on each side.

ENGINE ROOM:

The engine room is fronted by a thick gasketed Diamond Sea Glaze door with inspection window. The large John Deere main engine is on centerline. Immediately to starboard upon entry is the gravity fed supply tank which receives fuel from the four main fuel tanks and distributes to the main engine and the generator (note: the wing engine has its own supply tank). On the starboard fuel tank bulkhead the plumbing manifolds for fuel return and fuel transfer are neatly arranged. There is also an oil change system installed. The engine room also includes a Sea Fire fire suppression system. There is a proprietary dual inlet seachest located on centerline beneath the main engine shaft which provides cooling water for the wing engine, generator, air conditioning, etc. Aft on the starboard side is the Lugger wing engine and day tank.

Aft to port is the Northern Lights 20kW generator. The floor panels are designed with removable lids in key areas for access to service and inspection. All the way aft is a door to the lazarette which is a great feature since it provides underway access to the steering, inverter and batteries without having to go on deck. The spaciousness in the engine room for getting around and observing provides the crew with areas to stand and/or sit making this vital area of the boat easy to inspect, service and maintain.

LAZARETTE:

Nordhavn 55 Terrapin

Located beneath the aft deck cockpit, the lazarette is accessed via a massive fiberglass deck hatch (or through the door from the engine room). The dual hydraulic steering is located aft and there is also an emergency tiller mounted. There are several through hulls – all easy to get to. Xantrex SW series inverter/battery charger, Mastervolt charger, Lifeline batteries, stern thruster, air conditioning and davit control motor are all neatly installed for secure operation. This important space is protected by a built in Sea Fire system. This lazarette is a working space that is easy to get around in for routine maintenance and inspection.

EXTERIOR:

SWIM PLATFORM:

Terrapin was ordered with the optional swim platform extension that makes for a great deck space behind the cockpit which doubles as a nice dock for arriving by dinghy. This is a great place to jump in for a swim and a convenient way to board the boat via dock from either side. The swim step platform also features a hot/cold freshwater shower for convenient washing off.

COCKPIT and STARBOARD SIDE DECK:

The cockpit allows an area for relaxing and also incorporates a nice curved stairway up to the boat deck. Forward there is a fiberglass console with a sink and locker. Access to the lazarette is provided by a huge hatch and you can also walk forward on the covered starboard side deck all the way to the foredeck. There is a boarding door aft and also one amidships on the starboard side for easy dock traffic mobility.

FOREDECK:

The Foredeck is entered from the centerline of the Portuguese bridge via a hinged door. You have shore power connections up forward and an assortment of deck hatches which provide natural airflow into the forward stateroom and head. There is a fresh water hose bib in the foredeck entry way door steps.. The ground tackle arrangement allows for two anchors and includes an electric windlass and a cavernous chain locker secured by a commercial grade Freeman hatch.

BOAT DECK:

The boat deck, where the tender is stored, is accessed by ascending the stairway from the cockpit or by coming aft along the port side from the pilothouse. This large deck is directly over the saloon and provides a huge landing pad for the ships tender. There is an Aritex crane installed to port for launching and retrieving the 13' Walker Bay inflatable with 50HP Yamaha outboard.

FLYBRIDGE:

Clearly a highlight of the 55 is the view from the flybridge, this is a wonderful place to operate the yacht and also a great place to relax and enjoy your anchorage. There are two tastefully re-upholstered helm chairs forward of a fiberglass lunch table with built in bench. All necessary navigation gear is installed for simplicity of operation underway and this is actually an ideal place to get a great perspective while docking. Navigation equipment includes the Simrad autopilot, GPS, Icom VHF, stereo, search light pad, Argonaut monitor display for radar and chart plotter, stabilizers, windlass control plus more. There is a stainless steel canvas wrapped folding Bimini top to keep the sun and rain away. The storage area underneath the forward coaming is huge.

HIGHLIGHTED FEATURES & EQUIPMENT INCLUDED WITH TERRAPIN

© 2018 Jeff Merrill Yacht Sales, Inc. All Rights Reserved. www.JMYS.com

Nordhavn 55 Terrapin

MACHINERY AND FUEL SYSTEM FEATURES:

- **John Deere 6081** main engine (keel cooled with dry stack exhaust) with a **ZF** transmission on a 4:1 reduction gear spinning a five-blade propeller
- **Spurs** line cutter on main and wing engine shaft
- **Lugger L-984D** 70 HP wing engine with folding **Gori** propeller and 10-gallon day tank
- **ABT Trac #250** digital active fin stabilization
- **Sidepower** 24V electric bow thruster
- **Sidepower** 24V electric stern thruster
- **Cruisair** air conditioning with four zones– saloon, pilothouse, master and guest stateroom. This system includes reverse cycle heating when warm air is desired.
- **SeaFire** fire suppression system for engine room and lazarette
- **Oberdorfer** oil changer for main, wing and generator
- Dual inlet sea chest for raw water cooling including custom chest vent
- Dual **Racors** for Main engine and Racor fuel filter with fuel transfer manifold

ELECTRICAL SYSTEM FEATURES:

- **Xantrex** pure sine wave inverter with battery charger
- **Mastervolt** battery charger – 100amp
- **Marinco** TV/Phone inlet
- **Northern Lights** 20 kW Generator
- AC electrical system includes galvanic isolator
- Shore power connections in cockpit and on foredeck
- (2) 50' 50-amp shore power cord
- **Lifeline** AGM batteries
- Lightning ground system
- **Glendinning** shore power cord system at stern
- Overhead lights with dimmers in saloon, pilothouse, master stateroom
- SSB ground with dyna plate
- Inverter bypass breaker set up in lazarette

GALLEY, LAUNDRY AND PLUMBING FEATURES:

- Fresh water deck wash down at bow, stern, engine room and boat deck
- **Scandvik** cockpit shower
- **Tecma** fresh water electric toilets in heads
- Stainless steel sink
- **Grohe** faucet
- **Raritan** 20-gallon hot water heater
- **Headhunter Mach 5** fresh water pump – 110V
- **Par Max** back up fresh water pump – 24V
- **Village Marine PW1200** - 1,200 gallon per day water maker
- **GE Profile** convection microwave – outboard above stove
- **GE** 18" dishwasher
- **SubZero** 700TC refrigerator
- **SubZero** freezer drawers with icemaker
- 30" **GE Profile** gas cook top with four propane burners
- **GE** 240V electric oven
- **Broan** trash compactor with teak face
- Granite counter tops in galley and heads
- **Bosch** clothes washer and **Bosch** clothes dryer (both front loading)

© 2018 Jeff Merrill Yacht Sales, Inc. All Rights Reserved. www.JMYS.com

Nordhavn 55 Terrapin

- Pantry lockers and drawers
- Deep Freezer in utility room

NAVIGATION & COMMUNICATIONS ELECTRONICS, WHEELHOUSE FEATURES:

- **Deere** main engine panel with **Murphy** gauge – **MMC** controls
- **Lugger** wing engine panel with **Morse** controls
- Starburst pattern on pilothouse table
- Computer with Windows 7
- **Linksys** wireless network router (not connected)
- 19 **Argonaut** sunlight viewable pilothouse screens
- 15” **Argonaut** sunlight viewable waterproof screens on flybridge with splitters
- **Interlink** wireless RF keyboard and mouse
- **Furuno** 6kW 4.5’ open array radar
- **Nobeltec Trident** software with target acquisition
- **Nobeltec** passport electronic charts
- **Nobeltec** sounder with Airmar triducer for depth, speed and temp
- **Furuno** sounder with depth transducer
- **Furuno** FD50 AIS
- **Comnav** GPS heading sensor connected to computers
- **XM** weather receiver (disconnected)
- **NMEA** 2000 backbone with color displays in pilothouse and OSR showing weather, speed, depth and water temp
- **Maretron** USO ultra sonic wind and weather station on NMEA network
- USB long range wireless Wi-Fi access for marinas
- **Simrad** AP25 auto-pilot with two stations and **Accusteer** HPU-I50 with soft shift pump
- **Furuno** NavPilot 700 with **Accusteer** HPU-212-200 pump
- **Icom** M-504 VHF radio with loud hailer function
- **Icom** M-506 VHF radio on flybridge
- **Icom** M-802 SSB radio

Nordhavn 55 Terrapin

- Wireless cellular phone amplifier
- **Marinco** TV/Phone exterior inlets
- **Glomex** TV antenna
- **FLIR** night vision
- **KVH** 7 satellite communications
- **Nobeltec** chart software
- 30" stainless steel vertical destroyer wheel
- Electric horn
- Windshield wiper controls
- **TZT** 14 "repeater" on flybridge
- **Furuno** 3D 24" Radar dome (back up radar)
- **Maxwell** windlass control
- **Sidepower** joy sticks for bow and stern thruster – with remote
- **Ritchie** compass
- **Stidd** helm chair
- **Village Marine** water maker control panel
- **Weems and Plath** Clock
- **Weems and Plath** Barometer
- **ABT TRAC** active fins stabilizer panel
-
- **MMC** electronic engine controls for main engine – pilothouse, flybridge, cockpit and starboard wing
- **Maretron** system

HULL, DECK, COCKPIT & FLYBRIDGE ADDITIONAL EQUIPMENT:

- **Maxwell 3500** electric windlass
- 400 feet 1/2" HT chain
- 110 KG **Rocna** anchor with swivel and chain stopper
- Foredeck wash down
- **Fortress FX85** spare anchor & chain & rope
- **Walker Bay** RIB 13' rigid inflatable with center console with cover
- **Yamaha** four stroke 50 HP outboard (skid pad on deck)
- Dinghy hull chocks and tie downs
- White mesh screens for windows
- Bimini top – stainless steel folding frame, **Sunbrella** cover
- (2) helm chairs on flybridge
- **Argonaut** navigation color monitor
- **TZT** navigation color monitor
- **Simrad** autopilot on flybridge
- **Furuno** autopilot on flybridge
- **ICOM** VHF radio
- Controls on flybridge for bow thruster, **ABT** stabilizers and windlass
- Flag halyards
- Large teak ensign staff (varnished)
- Chain stopper on primary anchor

Nordhavn 55 Terrapin

- Starboard side docking station on Portuguese bridge and cockpit docking station with engine and thruster controls, horn and windlass toggle
- Extended Swim platform
- Hot and cold fresh water shower
- Stern teak caprail - varnished
- Fishing rod holders
- Stainless hand rails in numerous additional places on deck

INTERIOR ADDITIONAL EQUIPMENT:

- Custom window covers for windows and hatches
- Designer accent pieces throughout
- **Webasto** diesel heating system with vents in saloon, master and guest stateroom
- **Cruisair** air conditioning system with remote compressors
- **Oceanair** screen/shades on master hatches
- 40" **Sony** flat screen TV on remote control lift in main salon
- **Seatel** coastal 24" dome satellite tracking television with (2) RF receivers
- **Bose** 123 AV system in saloon with DVD/CD player with tuner and two speakers with sub-woofer
- **Pioneer** stereo in pilothouse with XM input
- Custom bed mattresses in master stateroom and guest stateroom

SAFETY EQUIPMENT:

- **Rescue** 6-man offshore life raft (note: recertified June, 2017)
- EPIRB
- High water bilge pump
- **Lifesling**
- All USCG safety equipment

TERRAPIN – RECENT (2017) UPGRADES

- Added boat deck stack fans for engine room cooling
- Added TZ touch to flybridge
- Deep cleaning and detail in May 2017 interior and exterior

ADDITIONAL COMMENTS:

Terrapin is a USCG documented and registered vessel with US duty paid. The hull and topsides have been cleaned and waxed on a regular basis. All of the systems are proven and her equipment is sound. If you are in the market for an outstanding long-range passage maker at an exceptional price, please give *Terrapin* a very close look. An extensive photo inventory of *Terrapin* is available by request.

Nordhavn 55 Terrapin

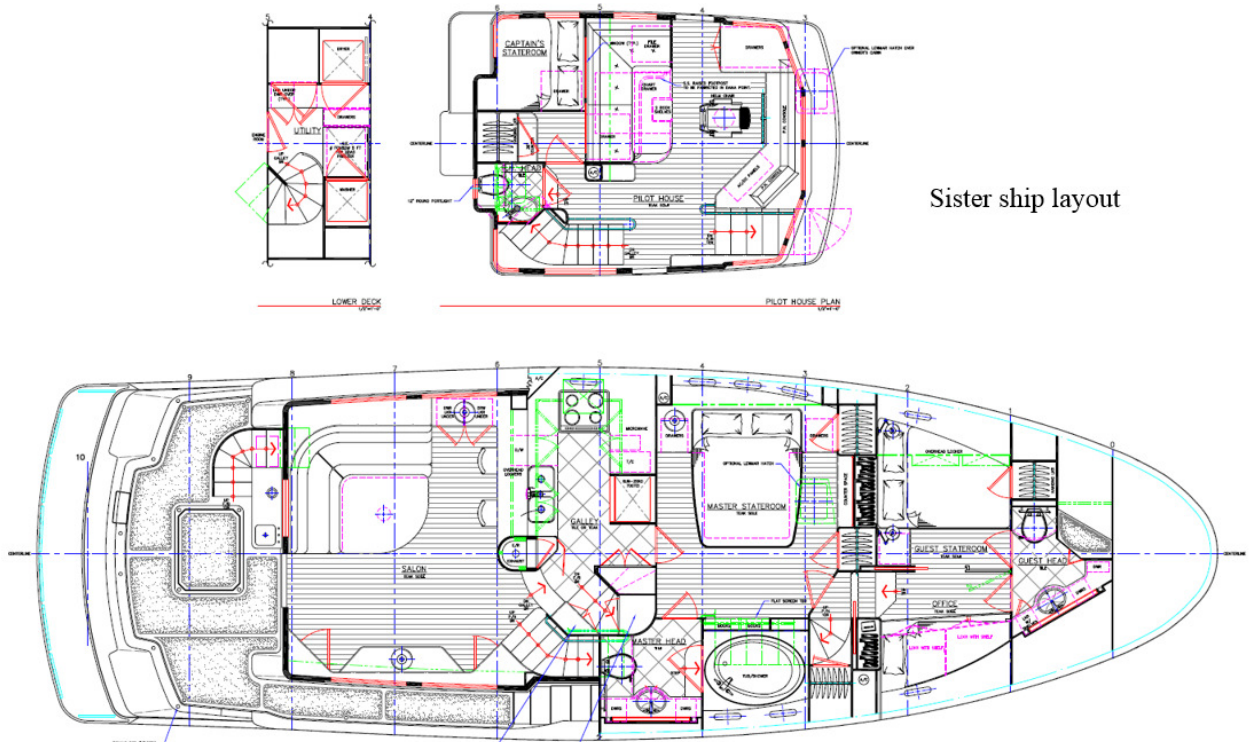

EXCLUSIONS:

Potential purchasers should assume that items on the vessel at the time of viewing, but not specifically listed on this sheet, are not included with the sale of the yacht. These specifications are believed to be true and correct, but cannot be guaranteed. Items excluded include, but are not limited to – Paintings, diving gear, Tools and Binoculars. Owner’s personal effects and clothing will be removed prior to closing.

DISCLAIMER:

Specifications and details of this vessel are provided in good faith for informational purposes only. Details regarding the specifications, operating characteristics and condition of the vessel have been obtained from sources believed reliable, but the owner and brokers cannot guarantee or warrant the accuracy of this information or the condition of the vessel. Buyer assumes responsibility to verify all speeds, capacities, consumptions and other measurements contained herein and otherwise provided and agrees to instruct his/her agent or surveyor to confirm such details prior to purchase. Photos may include items that are not included in the purchase price. Vessel is offered subject to prior sale, price and inventory changes and withdrawal from market without notice.

SALES CONTACT DETAILS:

About the listing brokers: Jeff Merrill, CPYB (Certified Professional Yacht Broker) and Ray Danet, have extensive product knowledge of the trawler market and intimate knowledge of the Nordhavn 55 in general *and Terrapin* specifically. Please contact listing brokers, **Jeff Merrill, CPYB** or **Ray Danet** for additional information or to schedule a viewing appointment to inspect *Terrapin*.

Nordhavn 55 Terrapin

Ray Danet

Mobile phone: +1 772.215.9616 – call or text

Email: RayDanet@gmail.com

~or~

Jeff Merrill, CPYB

Mobile phone: +1 949.355.4950 – call or text

Toll Free: 866.748.5419

Email: Jeff.Merrill@JMYS.com

Jeff is always available via Mobile (949) 355-4950 (call or text). You can send a detailed Email to: Jeff.Merrill@JMYS.com.

Jeff Merrill, CPYB

Mobile phone: +1 949.355.4950 – call or text

Toll Free: 866.748.5419

Email: Jeff.Merrill@JMYS.com

Skype: jeff.merrill

You Tube: Jeff Merrill Yachts

Website: www.JMYS.com

Instagram: jeffmerrilljmys

Certified Professional Yacht Broker

Licensed and Bonded in California and Florida.

Member California Yacht Brokers Association – President 2015 and 2016

Member Florida Yacht Brokers Association

Member Northwest Yacht Brokers Association

Member Yacht Brokers Association of America

Twitter: @merrillyachts

LinkedIn: jeff.merrill

Facebook: Jeff Merrill Yacht Sales

Nordhavn 55 Terrapin

If you would like to step aboard, please contact Jeff or Ray to make an appointment and see for yourself why **Terrapin** is such an extraordinary Nordhavn 55.



Jeff Merrill, CPYB +1 949.355.4950 Jeff.Merrill@JMYS.com



Ray Danet +1 772.215.9616, RayDanet@gmail.com

