

## Nordhavn 63 Kokomo



**JEFF MERRILL**  
YACHT SALES, INC.

3010 Old Ranch Pkwy, Suite 440, Seal Beach, CA 90740  
+1 949.355.4950 | [www.JMYS.com](http://www.JMYS.com)



## ***KOKOMO***

**Asking: \$2,095,000.00      Location: Stuart, FL**

***Kokomo***. The name conjures up an exotic tropical destination to many of us; one of sunshine, sandy beaches, palm trees and a soft breeze. Living up to this ideal, the Nordhavn 63 ***Kokomo*** has embarked on many enchanted adventures over the past three years. Her cruising itinerary started with delivery and commissioning in California in late 2015 and then she sailed south - venturing to remote islands off of Mexico and central America. After transiting the Panama Canal, ***Kokomo*** toured the Caribbean and Bahamas before arriving in Florida. 15,000 sea miles and more than 2,000 engine hours later, ***Kokomo*** has delivered everything that the promise of a solid passage making trawler is expected to, and more.

The independence that a well-planned and properly outfitted trawler makes possible allows freedom that is unimaginable, unless you have been fortunate enough to participate in this extraordinary

Jeff Merrill Yacht Sales, Inc. © 2018 All Rights Reserved [www.JMYS.com](http://www.JMYS.com)

## Nordhavn 63 Kokomo

lifestyle. Periodic trips to civilization were required for re-provisioning and to exchange on board guests but heading back out was always next on the agenda. Through all of this active cruising, **Kokomo** has been routinely maintained to rigorous standards. He is an engineer by profession and understands the importance of looking after machinery and managing every piece of equipment to ensure reliability.

Now, the owners reflect upon fond memories of numerous trips to pristine paradise, always in comfort and style, often arriving and remaining as the only vessel around for miles. The photos of **Kokomo** are a testament to what you can find when you create your own path.

Every boat has a story, some more interesting than others. **Kokomo** completes the latest chapter in the life of a seasoned mariner who, along with his wife, savors trawler travel across the sea as much as they both enjoys exploring below the surface as accomplished SCUBA divers. He was a pioneer of the underwater lifestyle helping to introduce this sport to Europe.

After selling their previous long-range trawler several years back (the Nordhavn 55 **Starfish**), they took a break from offshore travel, satisfied. Until PAE tempted them by announcing a new concept that inspired them to consider a new way they could head back offshore with friends to explore and pick up right where they left off. The more they studied the plans, the more intrigued they became. Soon they were seriously considering the enticing package of the Nordhavn 63. It didn't seem possible that the same hull mold could be re-imagined with so many innovations. They studied the layout and carefully considered what they would want to add and how they would outfit and equip a new Nordhavn 63.

The aft pilothouse and lower center of gravity would certainly behave well in heavy seas (and they had always been smitten by the Nordhavn 62's looks and continued history of successful crossings). The new interior layout would add more versatile sleeping accommodations. The size is just right, and by upgrading to hydraulic thrusters, adding a second generator and numerous other thoughtful improvements, they would have everything they needed and still find it easy to remain in control as owner/operators.

After so many years in the sun a flybridge had lost its' importance; but the covered upper aft deck and cockpit would provide protected outdoor living areas. Moving the wheelhouse back makes a lot of sense and the larger upper deck space would obviously make piloting more comfortable, especially with two helm chairs side by side. Retaining the master stateroom amidships and offering a spacious VIP guest stateroom forward is ideal for two couples. Adding a shower to the day head in the pilothouse enhances the captain's cabin and total pilothouse environment. Side by side helm chairs makes perfect sense. The conjoined saloon and galley makes for a generous gathering space for sharing meals or just relaxing to enjoy a movie on the flat screen or, to tune out and read. The expanded utility room forward of the engine room provided enough room for a crew to sleep in a single berth.

Before placing the order, they flew over from Europe to Seattle, Washington to step aboard hull number three and see if this marvelous design was as delightful in person as she appeared on paper. As you have guessed, it was "have-to-have-one" at first sight and a very well thought out order was placed using their previous Nordhavn experience. They included all of the essentials needed to create the independence and freedom they desired.

# Nordhavn 63 Kokomo

Some of the key attributes and features of **Kokomo** are:

- Aft Pilothouse, low profile offshore design
- Solid fiberglass hull, thick and rugged for ocean crossing
- Exquisite interior finish with clean teak joinery, granite and onyx counters and pleasing soft goods/decor
- Wide body (starboard side deck) salon layout
- Master stateroom aft with large walk around bed – ensuite head and shower
- VIP Island berth forward – hallway head and shower
- Captain’s cabin (sleeps two) in aft portion of pilothouse – separate head and shower aft in pilothouse
- Pilothouse has two Stidd helm chairs, extensive nav/com electronics package (Furuno, Simrad, KVH, etc.) and seating with table
- Salon has a long settee to starboard, an L-shaped settee to port with large dining table, TV lift forward dividing galley and wine cooler to starboard.
- The galley includes a propane cook top, electric oven, dishwasher, trash compactor, dual Sub-Zero refrigerators and freezer drawers, microwave convection oven
- Utility room forward of engine room has separate clothes washer, clothes dryer and freezer plus crew bunk
- Expansive foredeck with AB Oceanus RIB tender/ Yamaha 70 HP outboard, Steelhead crane, Marquipt ladder and Maxwell 4000 hydraulic windlass
- Upper outside deck has stainless steel framed awnings overhead, built in seating with table behind the pilothouse and Portuguese bridge deck forward features docking stations outboard on both sides and dinghy gasoline storage.
- Extended swim platform aft merges into covered cockpit with built in barbeque and wet suit locker
- John Deere 6090AFM main engine (320HP) with keel cooled, dry stack exhaust with dual alternators
- John Deere 4045DFM wing engine (80HP) independent propulsion package
- Hydraulics package – powered by main and/or wing – runs active fins, thrusters, windlass, etc.
- ABT TRAC 300 hydraulic active fin stabilizer fins
- Two generators, Northern Lights 20kW and Northern Lights 16kW
- Two Outback inverters
- ASEA 15kW frequency converter
- Two Parker Sea Recovery 800 GPD water makers
- SeaFire fire suppression systems in engine room and lazarette
- Membrane Nitrox compressor dive system and associated SCUBA gear
- Winslow 8-person life raft and EPIRB
- Flopper stoppers port and starboard
- The cavernous engine room is easy to move around and stand up forward. The main is on centerline, wing to starboard and large generator to port. Fuel manifold system, oil change

# Nordhavn 63 Kokomo

system, fire suppression, hydraulics for stabilizers, Groco strainers and bilge pumps. Hand tools mounted.

- The spacious lazarette stows the air-conditioning, inverters, batteries, small generator, ASEA frequency converter, fire suppression, dual water makers, stern thruster, rudder with dual steering pumps
- Beneath the VIP stateroom is the forward basement machinery space with bilge pump, hot water heater, fresh water plumbing manifolds, dual fresh water pumps, hydraulic pump for windlass, anchor wash, bow thruster and bilge pump plus storage shelves

The next owners of **Kokomo** will benefit from the experience and lessons learned building two new Nordhavns from scratch. You really need to step aboard to take it all in and only then will you begin to appreciate much of the carefully determined decisions that have optimized, maximized and captivated all who have been aboard.

**Kokomo's** price reflects the sellers hope that an astute buyer will comprehend the extraordinary value and incredibly attractive presentation being offered.

There is a detailed equipment list, many photos (including 360 images) and a walk-through tour video to fill out the whole picture.

If you would like to schedule an appointment or have any questions that you would like to ask, please contact the listing brokers to open up the conversation.

<b>YACHT NAME:</b>	<b>Kokomo</b>
<b>BRAND AND MODEL:</b>	NORDHAVN 63
<b>TYPE:</b>	Long range passage maker with raised aft pilothouse
<b>LOCATION:</b>	Stuart, FL
<b>MODEL YEAR:</b>	2015
<b>HULL NUMBER:</b>	8
<b>HULL COLOR:</b>	White gelcoat hull with blue whale and boot top stripes. Gray nonskid on deck. Black bottom paint.
<b>REGISTRY:</b>	Gibraltar, UK
<b>DESIGNER:</b>	Jeff Leishman
<b>BUILDER:</b>	P.A.E./South Coast – Xiamen, China
<b>HULL MATERIAL:</b>	Solid Fiberglass
<b>DISPLACEMENT:</b>	143,000 lbs.   64.86 MT
<b>BALLAST:</b>	19,809 lbs.   8,985 KG (Lead)
<b>RANGE:</b>	2,500 miles @ 8.3 knots
<b>SPEED:</b>	Cruise 8.3, Top 9.2 knots
<b>LOA:</b>	62'6"   19.05 M
<b>LWL:</b>	57' 3"   17.45 M
<b>BEAM:</b>	18' 0"   5.49 M
<b>DRAFT:</b>	6' 8"   2.02 M

# Nordhavn 63 Kokomo

<b>A/B:</b>	2.47:1
<b>AIR DRAFT:</b>	29' 7"   9.02 M to top of stack (est.)
<b>DECK:</b>	Molded in nonskid
<b>MAIN ENGINE:</b>	John Deere Turbo-Diesel   #6090AFM75   9 litre, 6 cylinder   320 HP continuous duty   (Main hours: ~2,290) June, 2018
<b>TRANSMISSION</b>	ZF   #ZFW325 4.4:1 reduction transmission
<b>PROPELLER / SHAFT</b>	3" Aqualoy 22 shaft   Spurs line cutter   Five blade propeller (42LH28.5)   Note: Propeller pitched for optimum cruising efficiency, not for WOT RPM match
<b>EXHAUST:</b>	Dry stack, keel cooled
<b>WING ENGINE:</b>	John Deere Turbo-Diesel   #4045DFM70 HE   4.5 litre, 4 cylinder   80 HP   ZF V-drive transmission with Gori 3-blade propeller (Wing hours: ~125) June, 2018
<b>THRUSTER(S):</b>	ABT Model TRAC 10 hydraulic 25 HP bow thruster   ABT Model TRAC 10 hydraulic 25 HP stern thruster
<b>STABILIZATION:</b>	ABT TRAC 300 digital active fin stabilizers with 12 sq. ft. fins   Anchor flopper stopper on both sides
<b>ELECTRICAL:</b>	60 Hertz – US style - 50 amp
<b>SHORE POWER:</b>	50 amp for house and air con (aft).
<b>GENERATOR 1:</b>	Northern Lights #M844 LW3.3 - 20 kW 240V 60Hz 83amps in engine room (Generator hours: ~1,300) June, 2018
<b>GENERATOR 2:</b>	Northern Lights #M773LW3 - 16 kW 240V 60Hz 66 amps in lazarette (Generator hours: ~2,115) June, 2018
<b>INVERTER/CHARGER:</b>	(2) Outback Model VFX3524 True Sine 3.5kW inverter / chargers. Paralleled and with bypass.
<b>BATTERIES:</b>	Lifeline AGM (1,020 combined total amp hours)
<b>FREQUENCY CONVERTER:</b>	ASEA AC15-1 frequency and voltage converter -rated 15kW / 15 KVA
<b>INTERIOR LIGHTING:</b>	LED cabin lights in salon, galley, heads, staterooms, pilothouse, lazarette and engine room
<b>NAVIGATION LIGHTING:</b>	Hella LED (6) Cruisair Direct Expansion Condensing Units Type EQ Models with (8) Cruisair Direct Expansion Cooling/Heating Units Model EBHE air handlers. 134,000 BTU (reverse cycle hot and cold air).
<b>CLIMATE CONTROL:</b>	
<b>WINDLASS:</b>	Maxwell VWC 4000 hydraulic
<b>GROUND TACKLE:</b>	Lewmar Delta (140 lb.) anchor (bent shank)   120M / 400' 1/2" chain   Secondary Delta 55 lb. anchor with chain
<b>CRANE:</b>	Steelhead Marine LTD, Model ES1500. 1,500-pound lift. (7' - 12' reach). AB Oceanus 14 VST RIB with 50 litre gasoline tank   Nav/Com - echo sounder depth, VHF, AIS   Yamaha 70 HP outboard   Dinghy not registered. Note:
<b>TENDER AND OUTBOARD:</b>	35-gallon gasoline tank in Portuguese bridge Furuno personal computer based (radars, plotter, depth, AIS, satellite compass)   (3) 24" touch screen monitors   Icom VHF's   Simrad autopilots   FLIR   KVH satellite telephone   (6) closed circuit television cameras   Nobeltec
<b>NAV/COM BRANDS:</b>	
<b>SEARCH LIGHT:</b>	ACR - Motor Driven Dual Beam Remote Control Searchlight Model RCL 300D (1931-3).
<b>ENTERTAINMENT:</b>	Samsung TV Saloon on 55" lift / Bose speakers / Stereo

# Nordhavn 63 Kokomo

<b>STATEROOMS:</b>	(4) total. (1) master aft sleeps two, (2) guest cabins forward each sleeps two
<b>BEDDING:</b>	(1) Captain's single bunk in utility quarters forward of engine room
<b>HEADS:</b>	Custom mattress cushion for each bed
	(3) Tecma Silence Plus (electric freshwater) Master, Guest, Pilothouse
<b>SHOWERS:</b>	(4) total. (1) Master head, (1) Guest head, (1) Pilothouse head and (1) swim platform outdoors.
<b>LAUNDRY:</b>	Bosch AXXIS separate clothes washer and clothes dryer
	GE Propane 5 burner stove top with electric oven   (2) SubZero refrigerators with freezer drawers   GE Dishwasher   GE Convection microwave oven with vent   GE Trash compactor   Seagull IV fresh water filter tap for cooking and drinking   Marvel Chateau Collection 6SDZE wine cooler in Saloon   Freezer in Utility room   Propane BBQ in cockpit.
<b>GALLEY:</b>	
<b>INTERIOR WOOD:</b>	Cherry - satin finish (raised panels)
<b>INTERIOR COUNTERS:</b>	Granite, Onyx and Teak counters
<b>INTERIOR UPHOLSTERY:</b>	Novasuede 'Strong White' overhead. Ultraleather #291-3719 'Champagne' upholstery on settees.
<b>INTERIOR FLOORING:</b>	Teak and spruce hardwood   Carpeting   Tile in galley   Lonseal in pilothouse and utility room
<b>TANKAGE:</b> (approx.)	
<b>FUEL:</b>	2,481 gallons   9,392 L (fiberglass)
<b>HOLDING BLACK:</b>	120 gallons   454 L
<b>HOLDING GRAY:</b>	110 gallons   416 L
<b>FRESH WATER:</b>	800 gallons   3,028 L
<b>WATER MAKER:</b>	(2) Village Marine 'Squirt' 800 gallon a day 240v water maker STW800 touch screen.
<b>FRESH WATER PUMPS:</b>	(2) Mach 5 110V plumbed for quick cross over
<b>MACHINERY EQUIPMENT:</b>	Oil change system with Oberdorfer pump   Isolation transformer   Balancing transformer
	(1) Edson 638AL manual bilge pump. (1) 24VDC Jabsco Electric Diaphragm Bilge Pump, Model 34600-0010 with Aqua Alarm Bilge Pump Counter Model 20045.
	(2) 24VDC RULE Model 16A Submersible Pump rated for 3,700 gph high water bilge pumps, (2) Pacer hydraulic high capacity. Central high-water alarm at bridge, central pump control panel with counter on bridge.
<b>BILGE PUMPS:</b>	Engine room SeaFire FD1300-M   Lazarette SeaFire FD1050-M   Note: both units have manual activation pull handles
<b>FIRE SUPPRESSION:</b>	Lightning ground system   Built in cockpit barbeque   (2) Stidd helm chairs in pilothouse
<b>ADDITIONAL EQUIPMENT:</b>	Membrane Nitrox compressor system   (6) diving tanks with stabilizing jackets   Apeks regulators including Suunto computers
<b>SCUBA:</b>	Winslow superlight ocean rescue 8 person   EPIRB   Smoke and CO detectors
<b>SAFETY:</b>	
<b>PHOTO DATE:</b>	Most detail photos were taken in June, 2018. Scenic shots provided by Seller.
	<b>Note: All information is believed accurate, but should be verified.</b>

# Nordhavn 63 Kokomo

## LAYOUT: Upper Deck

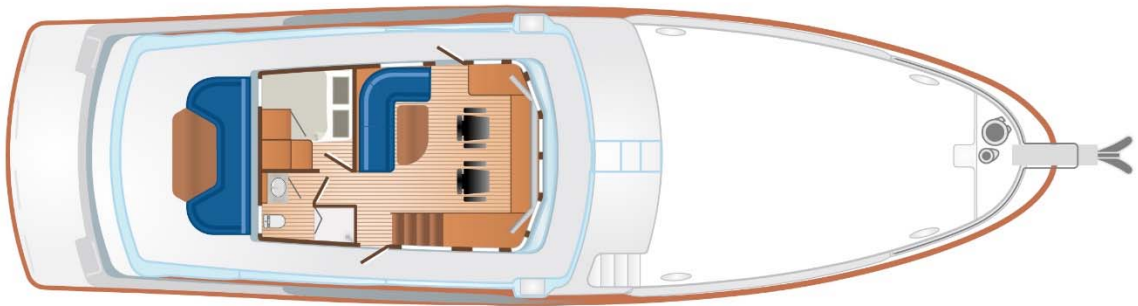

## LAYOUT: Main Deck



## LAYOUT: Lower Deck

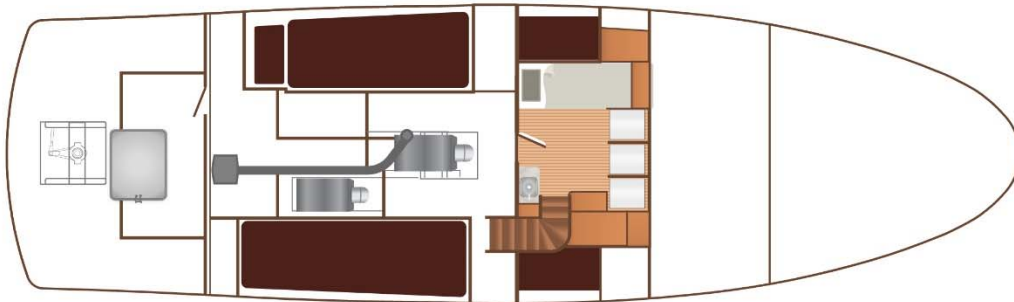

**Exclusions:** Potential purchasers should assume that items on the vessel at the time of viewing, but not specifically listed on this sheet, are not included with the sale of the yacht. These specifications are believed to be true and correct but cannot be guaranteed. Items excluded include, but are not limited to Paintings, tools, handheld nav gear and binoculars. Owner's personal effects and clothing will be removed prior to closing.

## Nordhavn 63 Kokomo

**Disclaimer:** Jeff Merrill Yacht Sales, Inc. presents the details of this vessel in good faith but cannot guarantee or warrant the accuracy of this information nor guarantee or warrant the condition of the vessel. Buyers should instruct their agents and their surveyors to investigate all details the buyers desire validated. This vessel is offered subject to prior sale, price change, or withdrawal without notice.

**Brokerage:** JMYS is a US based (licensed and bonded yacht brokerage in California and Florida) with an international emphasis specializing in ocean capable trawlers. Our brokers are experienced boaters, most are trawler owner/operators with thousands of hours and miles at sea. We treat our clients with respect, we are responsive and not pushy. Our focus is to become your loyal advocate, always looking out for your best interests. The team at JMYS has extensive trawler and motor yacht product knowledge and our skills are available for coaching after the sale has concluded.

**Co-Brokerage:** Fellow yacht broker association members: This listing is available for co-brokerage and JMYS is a 50/50 house. Courtesy showings are available by appointment. Florida listings subject to appropriate broker licensing required by law. All inspections are by appointment only.

**There is a YouTube video on JMYS.com you can watch featuring *Kokomo*:**



Please visit the dedicated website with additional information [www.Nordhavn63ForSale.com](http://www.Nordhavn63ForSale.com)



## Nordhavn 63 Kokomo

**\*Listing broker. John Hoffman.** John's Mobile is (772) 215-3720 (call or text). John's email is [John.Hoffman@JMYS.com](mailto:John.Hoffman@JMYS.com). John has been associated with the Nordhavn brand for over 10 years and has hands on knowledge of all systems and operations. Please contact John by phone, text or email for additional information or to schedule your personal showing. **Licensed and Bonded in Florida.** Member International Yacht Brokers Association and Yacht Brokers Association of America



**John Hoffman**



**\*Listing broker. Jeff Merrill, CPYB** (Certified Professional Yacht Broker) has extensive product knowledge of the trawler market and the Nordhavn brand. Jeff's Mobile (949) 355-4950 (call or text). You send an email to: [Jeff.Merrill@JMYS.com](mailto:Jeff.Merrill@JMYS.com). **Licensed and Bonded in California and Florida.** Member California Yacht Brokers Association – President 2015 and 2016  
Member International Yacht Brokers Association, Northwest Yacht Brokers Association and Yacht Brokers Association of America



**Jeff Merrill, CPYB**

