

Camano Troll 31 Sasta



JMYS

3010 Old Ranch Parkway, Suite 440, Seal Beach, CA 90740
+1 949.355.4950 | www.JMYS.com



Sasta

Asking: \$104,900.00

Location: Seattle, WA

Jeff Merrill Yacht Sales, Inc. © 2020 All Rights Reserved www.JMYS.com

Camano Troll 31 Sasta

In April of 2020 her hull was professionally stripped of gel coat and faired out, followed by multiple coats of epoxy and finished with two coats of bottom paint (all Seahawk products). During this haul out, she also had her main engine intake seacock replaced, added new underwater zincs and had her propeller cleaned and protected with a barnacle treatment.

Sasta is a perfect example of why a Camano Troll is so well-liked and sought after!

The Camano 31' is a one stateroom, one head trawler with a huge salon and down galley. From the cockpit you can access the roomy flybridge and upper helm complete with a bimini canvas cover. Walk in the salon and it is open and airy with a lot of light and bright visibility. You can easily seat six at the settee on the port side and to starboard is the lower helm.

Sasta has been moored in a covered slip for most of its life and the last two years in covered freshwater moorage!

A brand new Raymarine eS78 Radar System – Hybrid Touch was just installed and ready for new owners to take on.

Sasta is an extremely clean, comfortable, efficient and seaworthy trawler. In regard to efficiency, it's been reported that it burns one to two gallons per hour. Make an appointment to see this wonderful "pocket trawler" **Sasta**!

LAYOUT:

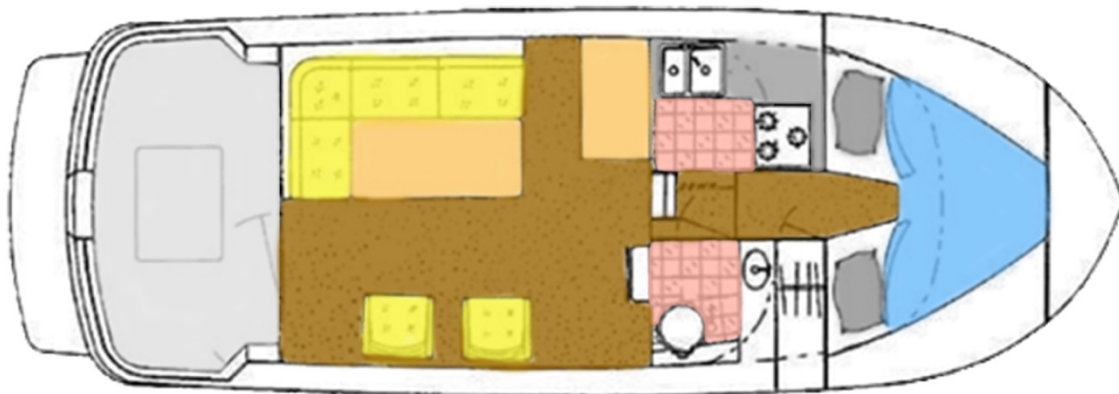

Camano Troll 31 Sasta

SPECIFICATIONS:

YACHT NAME:	<i>Sasta</i>
BRAND AND MODEL:	Camano Troll
TYPE:	Trawler style motor yacht with flybridge
LOCATION:	Seattle, Washington
MODEL YEAR:	2001
HULL NUMBER:	147
HULL COLOR:	Soft white with black window trim and black boot striping
REGISTRY:	Seattle, Washington
DESIGNER:	Bob Warman
BUILDER:	Camano Marine Ltd, Delta, British Columbia, Canada
HULL MATERIAL:	Solid Fiberglass
DISPLACEMENT:	10,000 lbs. / 4,535 kg
SPEED:	Cruise speed 8 -10 knots Top speed 13 - 15 knots
LOA:	31' 9.4 M
LWL:	26'3" 8 M
BEAM:	10'6" 3.2 M
DRAFT:	3'3" 0.9 M
AIR DRAFT:	11'6" 3.5 M bridge clearance
MAIN ENGINE:	Volvo Diesel 200HP TAMD41PA (Main hours: ~926 August 2019)
EXHAUST:	Wet Exhaust
MACHINERY EQUIPMENT:	Dual Racor fuel filters
STEERING STATIONS:	(2) Inside helm and flybridge
THRUSTER:	Key Power Bow thruster
ELECTRICAL:	30 amp shore power connection
INVERTER:	Heart Freedom 1500
BATTERIES:	(4) house and (1) engine start (all new in 2019) Promatic Battery Charger Link Battery Monitor
CLIMATE CONTROL:	Webasto diesel forced air heat
WINDLASS:	Maxwell electric windlass
GROUND TACKLE:	Bruce Anchor 10kg with 5/16" high test chain
TENDER:	AquaPro 8.5' Aluminum Hull RIB with 8 HP Yamaha outboard
DAVIT:	Weaver Davits at swim step
NAV/COM:	Raymarine eS78 Radar System Hybrid Touch (new August 2019) (Radar and chart plotter set up, more options available) Raytheon ST6000 Autopilot Raytheon ST60 Depth Sounder (2) VHF radios and compasses

Camano Troll 31 Sasta

STATEROOM:	Master forward v-berth with insert and settee pulls out to double bed (sleeps 4)
HEAD:	Vacuflush head with tank monitor
SHOWERS:	Handheld showers in head and cockpit
GALLEY:	Force 10 three burner propane stove and cooktop LG microwave Stainless steel sink
REFRIGERATION/ FREEZER:	Nova Kool Refrigerator/freezer
WINDOWS:	Curtains in Salon and Galley Exterior screens
INTERIOR WOOD:	Teak trim
INTERIOR COUNTERS:	Formica
INTERIOR UPHOLSTERY:	Fabric
INTERIOR FLOORING:	Carpet and vinyl with teak steps
ENTERTAINMENT:	Vizio 22" TV Prestige CD/AM/FM stereo
TANKAGE: (approx.)	
FUEL:	100 US gallons / 378 L (aluminum)
HOLDING BLACK:	15 US gallons / 57 L (plastic)
FRESH WATER:	70 US gallons / 265 L (plastic)
Note: All information is believed accurate but should be verified.	

Camano Troll 31 Sasta

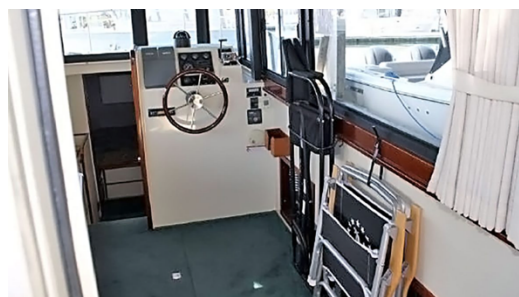

Exclusions: Potential purchasers should assume that items on the vessel at the time of viewing, but not specifically listed on this sheet, are not included with the sale of the yacht. These specifications are believed to be true and correct but cannot be guaranteed. Items excluded include, but are not limited to Paintings, tools, handheld nav gear and binoculars. Owner's personal effects and clothing will be removed prior to closing.

Disclaimer: Jeff Merrill Yacht Sales, Inc. presents the details of this vessel in good faith but cannot guarantee or warrant the accuracy of this information nor guarantee or warrant the condition of the vessel. Buyers should instruct their agents and their surveyors to investigate all details the buyers desire validated. This vessel is offered subject to prior sale, price change, or withdrawal without notice.

Brokerage: JMYS is a US based (licensed and bonded yacht brokerage in California, Florida and Washington) with an international emphasis specializing in ocean capable trawlers. Our brokers are experienced boaters, most are trawler owner/operators with thousands of hours and miles at sea. We treat our clients with respect, we are responsive and not pushy. Our focus is to become your loyal advocate, always looking out for your best interests. The team at JMYS has extensive trawler and motor yacht product knowledge and our skills are available for coaching after the sale has concluded.

Co-Brokerage: Fellow yacht broker association members: This listing is available for co-brokerage and JMYS is a 50/50 house. Courtesy showings are available by appointment. Florida listings subject to appropriate broker licensing required by law.

Camano Troll 31 Sasta

LISTING BROKERS:



Kelly Libby +1 425.359.7078 Kelly@JMYS.com

NYBA (Northwest Yacht Brokers Association)

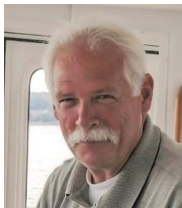

Greg Mustari, CPYB +1 360.507.9999 Greg@JMYS.com

Certified Professional Yacht Broker

NYBA (Northwest Yacht Brokers Association) Board of Directors

