

Selene 43 *Misty Pearl*



JMYS

3010 Old Ranch Parkway, Suite 440, Seal Beach, CA 90740
+1 949.355.4950 | www.JMYS.com

Jeff Merrill Yacht Sales, Inc. | 3321 SE 14 Avenue | Fort Lauderdale, FL 33316



Misty Pearl

Price: \$399,000.00

Location: Deltaville, VA

Jeff Merrill Yacht Sales, Inc. © 2020 All Rights Reserved www.JMYS.com

Selene 43 Misty Pearl

Misty Pearl is an ideal trawler to provide you access to the cruising lifestyle. She is a veteran of both the Great Loop and the Down East Circle. The 15th hull in the series, **Misty Pearl** benefits from extensive updating as she continues her cruising pedigree. She is absolutely ready to go wherever your cruising plans might take you.

Misty Pearl is an excellent example of the collaborative efforts of Ted Hood and Howard Chen when they set out to build long range live aboard trawlers that combine highly desirable features such a Portuguese bridge and walk around decks with high end finishes, which make **Misty Pearl** as comfortable to live aboard as she is to cruise and dock. High bulwarks around the deck add safety and convenience to her commonsense design. As she has demonstrated, she is a "Go Anywhere" vessel, comfortable at sea and with the range to cross oceans.

DESCRIPTION:

Cockpit: The cockpit is a wonderful place to spend time. There is plenty of shade from the full boat deck above and you can easily move from either side up to the raised pilothouse. Large doors on either side of the cockpit make boarding **Misty Pearl** safe and easy. Under the cockpit decking is the lazarette hatch which provides access to a large storage area, steering components and the aft freshwater tank. There is also a transom shower which can be raised to use on the swim platform or in the cockpit. The Grunert Freezer has been decommissioned.

Saloon: A Diamond SeaGlaze Dutch door leads into the saloon which has an L shaped leather settee to port with storage underneath. There is an adjustable table which raises and lowers as well as folds for dining and socializing. The entertainment center to starboard contains a newly installed Bluetooth-compatible Clarion Stereo and a 36" flat-screen TV.

- Hi/Lo folding table
- End cabinet with storage
- Entertainment cabinet with new Clarion Bluetooth compatible stereo and 36" Samsung flat-screen smart TV with DirecTV (all new 2018)
- Adjustable blinds on all windows
- Marine-grade speakers in ceiling
- Slide windows with screens
- Controls for main deck AC and heat
- Seth Thomas ship's clock and barometer
- Full hatch access to full-beam commissary with wine cellar
- Leather chair and ottoman (new 2018)
- Two Ocean Frigast reading lights
- Ten-year smoke/CO2 alarm (new 2018)

Galley: Moving forward on the same level as the saloon is an efficient galley with a full range of built in appliances including a Vitrefrigo 110V/12V refrigerator/freezer (new 2018), a Seaward Princess three-burner electric stove and oven with broiler and a GE Profile microwave oven with exhaust fan. There is an ample amount of workspace on the beautiful wrap around Corian countertops. Continuing forward

Selene 43 Misty Pearl

to the starboard of the galley are stairs leading to the raised pilothouse. Stairs to the port side of the galley lead to the stateroom companionway with engine room access.

- Vitrefrigo 110V/12V refrigerator/freezer (new 2018)
- Seaward Princess three-burner electric stove and oven with broiler
- GE Profile microwave oven with exhaust fan
- Multiple drawers and cabinets for storage
- Corian countertops
- Concealed trash-bin with access from galley or saloon
- Double stainless steel sink
- Additional 110V refrigerator in cabinet along companionway stairs to pilothouse
- Fresh water filtration system (new 2018)

Pilothouse: The Pilothouse is accessed by a few steps to starboard of the Galley. As you enter the Pilothouse you notice a full suite of Garmin electronics complete with touchscreen control and with all chart software up to date. At the helm you will find joystick control for both bow and stern thrusters making docking a controlled process. There are also controls for the anchor windlass which means that single handling this boat is not a problem. Well laid out electrical panels are easily accessible as are the controls for the generator, inverter and air conditioning systems.

- Garmin 7616 MFD touchscreen chart plotter with all software and charts updated
- Raymarine GPS GP300
- Ritchie compass
- Interphase Probe sonar
- NAIAD stabilizer Multisea II control panel
- Bow and stern thruster joystick controls
- Muir anchor winch controls
- Xantrex battery and charger system controls
- Onan genset monitor panel
- Cruisair AC and heat controls
- Simrad AP320 Autopilot
- Marine-grade speakers and controls
- Anchor winch remote controls
- Retractable chart table with underneath storage
- Raised leather bench helm seats with storage below
- Ocean Frigast reading light
- Diamond SeaGlaze Dutch doors port and starboard
- Hynautic hydraulic steering
- Overhead hatch with screen, blackout screen and canvas cover
- Opening and screened side windows port and starboard
- Interior Textilene window covers
- Classic Large wooden wheel
- Leather watch berth

Selene 43 Misty Pearl

Guest Stateroom: The stateroom accommodations are accessed down a few steps located to the port side of the galley. As you come down the steps you find the guest stateroom to port. Here you find upper and lower berths each with foam toppers. There is a large cedar-lined hanging closet which helps keep your wardrobe fresh. There are two Ocean Frigast reading lights along with individual controls for the air-conditioning and heat. Fresh air enters the space through two screened portholes and there is a folding bi-fold door which can be closed for privacy or left open for a spacious feel.

- Upper and lower berth
- Foam toppers on both berth
- Large drawer under lower berth
- Large cedar-lined hanging closet
- Two Ocean Frigast reading lights
- Burl-topped cabinet with drawers
- AC and heat control
- Two opening screened portholes
- Bi-fold door can be closed for privacy or folded back for space

Guest Day Head: The guest head features a separate shower enclosure, a quiet flush electric head, a vanity and medicine cabinet all highlighted by a beautiful Corian countertop with built in sink. Fresh air is circulated via two opening screened portholes supplemented by an exhaust fan.

- Separate shower enclosure
- Quiet Flush electric head
- Vanity with mirror, light, medicine cabinet and top storage
- Corian countertop with built-in sink
- Grohe fixtures
- Two opening screened portholes
- Exhaust fan

Owner Stateroom: Continuing forward from the guest stateroom you will find the owner stateroom with a centerline queen berth with a foam topper and ample storage for spares and other items under the owner berth. The burl wood-topped bureaus and drawers add a finish that you will admire every time you see it. There are marine grade speakers mounted in the ceiling as well as a TV cabinet or storage cabinet to port and on the aft bulkhead. Two large overhead hatches complete with insect screen, blackout screen and canvas cover provide unlimited fresh air which circulates through opening portholes on either side of the cabin.

- Centerline queen berth with foam topper and storage underneath
- Two large cedar-lined hanging closets with lights
- Two burl-topped bureaus with drawers, one with mirror and light
- Storage along berth on both sides
- Port-side book rack
- Two Ocean Frigast reading lights

Selene 43 Misty Pearl

- Two marine-grade ceiling speakers
- AC and heat controls
- Controls for stateroom deck AC and heat
- Forward cabinets above berth
- Port-side TV or storage cabinet on aft bulkhead
- Overhead hatch with insect screen, blackout screen and canvas cover
- Two opening screened portholes on both side of stateroom
- Ten-year smoke/CO2 alarm (new 2018)

Owner Ensuite Head: The Owner head features a separate shower enclosure with a full tub! There is also a hand-held shower head as well as a Jabsco Quiet Flush Electric head with tank monitor. Like the day head, this owner head is beautifully finished with Corian countertops, built in sink and Corian backsplash.

- Separate shower enclosure with full tub
- Hand-held shower head extension
- Jabsco Quiet Flush electric head
- Sealand holding tank monitor
- Vanity with mirror, light, medicine cabinet, and top storage
- Corian Countertop and back-splash with built in sink
- Grohe fixtures
- Two opening screened portholes

Engine Room: Access to the engine room is through a door located aft in the companionway for the staterooms. There is enough room to move about and service all or the components located in the engine room. Power is from a single Cummins 6BTA 280 HP diesel engine. Examples of conscientious maintenance include replacement of the turbocharger in 2017 and a new after-cooler in 2018. Two 12V blowers provide circulation to maintain ideal engine room operating temps. All (6) of the house batteries were replaced in 2019 while the start and thruster batteries were replaced in 2018. Diesel fuel filtration is accomplished by dual Racor 1000 filters and a Racor 500 filter for the generator. Oil changes are convenient through the use of a Reverso oil change system plumbed to the main engine, the transmission and the generator. The 20-gallon Raritan water heater was replaced in 2019. In order to help with clean fuel **Misty Pearl** has a fuel polishing system and the ability to move fuel between tanks.

- Cummins 6BTA 280 HP
- New Turbocharger (2017)
- New Aftercooler (2018)
- Twin Disc MG-55050 transmission
- New cutlass bearings (2017)
- New dripless shaft seal (2019)
- Spur line cutter
- Two 12V DC engine room blowers
- New Exhaust Elbow and Jacket (2019)
- Side power bow and stern thrusters

Selene 43 Misty Pearl

- All (6) new AGM house batteries (2019)
- New start and bow thruster battery (2018)
- Naiad Stabilizers
- Racor 1000 dual primary filters on main engine
- Racor 500 primary filter for genset
- Reverso oil change system for main engine, transmission and genset
- Cruisair reverse cycle AC and heat, 56,000 btu with two compressors
- Manual bilge pump with three manifold valves
- Four automatic bilge pumps
- Forty-gallon holding tank with overboard and deck discharge
- Twenty-gallon Raritan water heater with heat exchanger (new 2019)
- Shurflo freshwater pump (new 2019) with spare
- Shore water intake on stern with pressure regulator
- Sea water wash down pump on bow
- Fuel polishing/balancing system
- Heads converted to fresh water (2016)
- All sanitary hoses replaced (2017)

Electrical:

- 12V DC, 110V AC, 230V AC systems
- LED lighting upgrade
- Galvanic isolator
- Copper bonding system
- Balmar 160 amp alternator with Balmar Max Charge regulator
- Pathmaker three bank battery combiner
- Onan 12.5 KW generator with sound shield
- Xantrex 3 KW inverter/charger
- All batteries enclosed in FRP boxes with strap-down lids
- Shore power outlets on shore and stern
- 25' 50 amp shore power cord
- 50" 50 amp shore power cord (new 2019)
- Marinco 30 amp splitter

Boat Deck: The large boat deck easily holds the AB 11'5" aluminum-hull inflatable dinghy powered by a 15 HP Yamaha 4-stroke with electric start (new in 2016). The entire deck has canvas windscreen at lifeline height as well as a custom dinghy cover, full beam Bimini and Bimini aft of the bridge. The dinghy is launched via remote controls for the electric winch. New lines and cables were installed in 2018.

Selene 43 Misty Pearl

Flybridge: The Flybridge is spacious, comfortable and complete with two captain's chairs (both protected by new canvas in 2018). The center helm station containing a Garmin 7612 Chart plotter is protected by a Plexiglas hinged cover. For entertaining there is a rail mounted Magma grill with cover (new 2018).

- Center helm station
- Two Captain's chairs, with canvas covers (canvas 2018)
- Hinged Plexiglas cover for instrument panel
- Canvas cover for instrument panel (new 2018)
- Rail mounted Magma grill, with cover (new 2018)
- AB 11.5 aluminum-hull inflatable dinghy
- 15 HP Yamaha 4-stroke with electric start and tilt (new 2016)
- Custom dinghy cover
- Full beam Stamoid Bimini
- Stamoid Bimini for aft of bridge
- Heavy-duty 1 ¼" stainless railings throughout
- Forespar mast and boom for dinghy (new lines and cable in 2018)
- Electric winch
- Spreader and anchor lights
- Port and starboard lightboards
- Flybridge EPIRB (new 2018)
- KVH TV5 DirecTV antenna (new 2018)

Exterior and Decks:

- House is white gelcoat and deck is molded nonskid gelcoat
- Hull Awlgrip white in 2014
- Overhead courtesy lighting and deck step lighting
- Muir Cheetah electric windlass with capstan
- Windlass controls at foredeck, both helms and handheld remote control
- 33 KG Rocna anchor with 300' 3/8 HT chain
- Six 35' ¾" oversized dock lines (2018)
- Two 50' ¾" oversized dock lines (2018)
- Six cylinder fenders with 15' lines
- Anchor bridle
- Teak rail covers
- Six heavy-duty recessed deck cleats
- Portuguese Bridge with recessed storage lockers
- Upgraded stainless window frames
- Custom Textilene cockpit screens
- Four-step removable ladder for swim platform

Selene 43 Misty Pearl

Safety:

- Automatic Engine Room fire suppression system (new 2018)
- USCG safety package
- Kidde Halotron – 1 55 lb. extinguisher with Engine Room access
- Three handheld fire extinguishers
- Sea Anchor
- Two throwable life rings on Flybridge
- Horn
- Engine room high water alarm
- Flare gun and flares
- Required US Coast Guard placards

PROFILE:

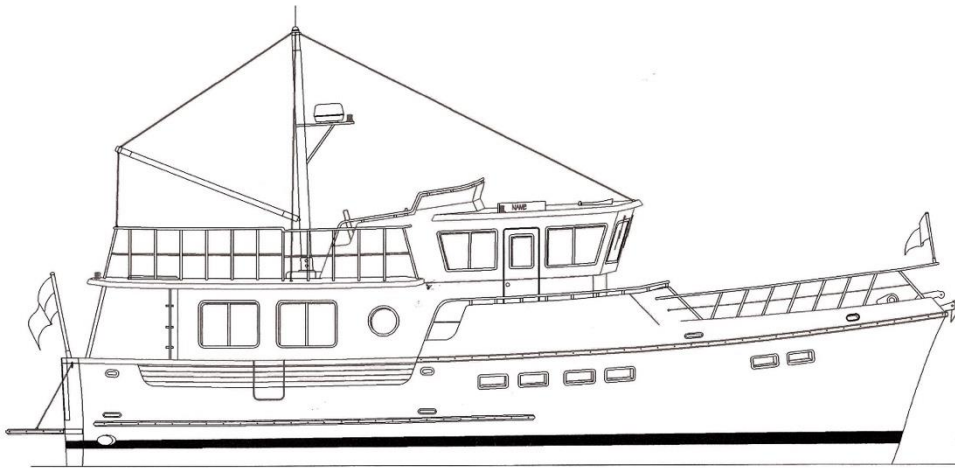

LAYOUT: Upper Deck Flybridge

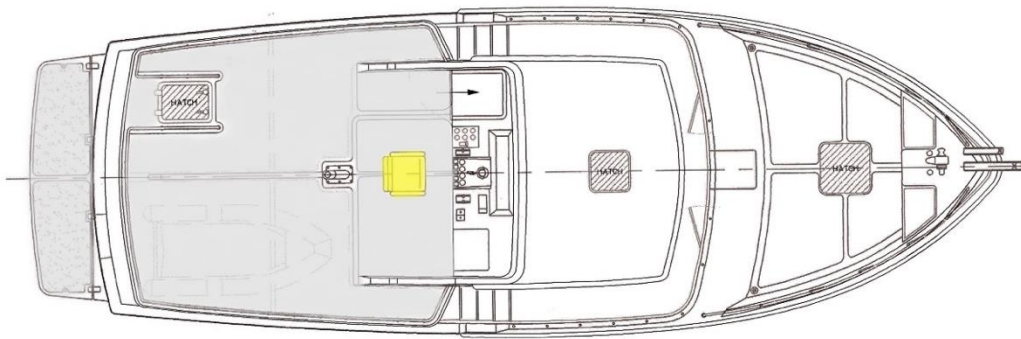

Selene 43 Misty Pearl

LAYOUT: Main Deck – Saloon, Galley, Pilothouse

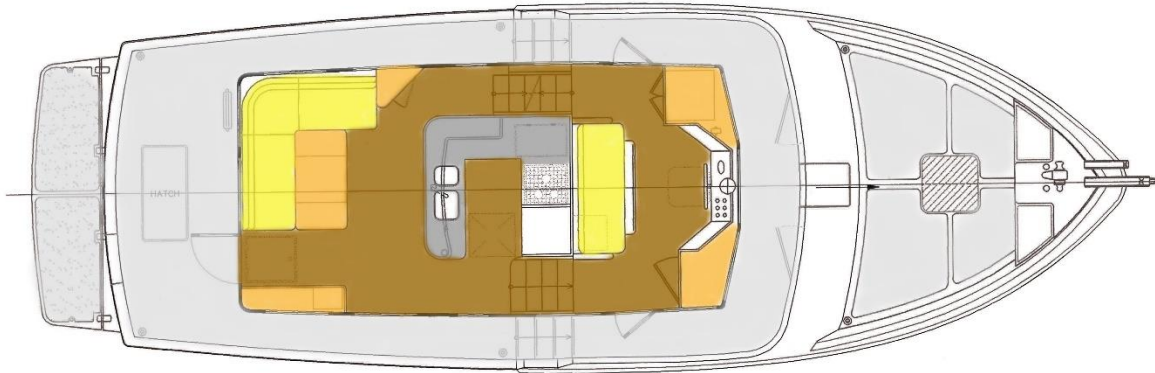

LAYOUT: Lower Deck – Engine Room, Staterooms, Heads

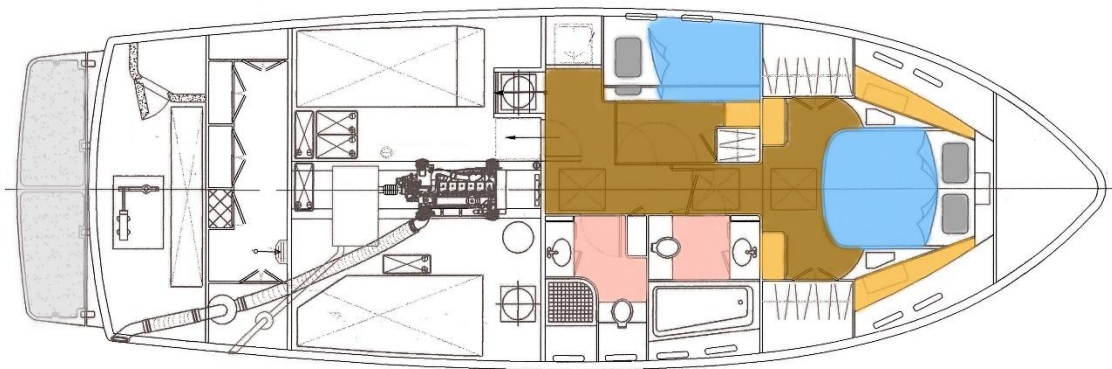

SPECIFICATIONS:

YACHT NAME:	<i>MISTY PEARL</i>
BRAND AND MODEL:	Selene 43
TYPE:	Long range trawler yacht with raised pilothouse and flybridge
LOCATION:	Deltaville, VA
MODEL YEAR:	2002
HULL NUMBER:	15
HULL COLOR:	White gelcoat

Selene 43 Misty Pearl

REGISTRY:	United States Coast Guard documented
DESIGNER:	Howard Chen
BUILDER:	Jet Tern Marine
HULL MATERIAL:	Solid fiberglass
DISPLACEMENT:	56,100 lbs. 25.45 MT
SPEED:	Cruise 7.7 knots @1800 RPM. Top 10 knots @ 2200 RPM
LOA:	47'7" 14.6 M
LWL:	42'4" 13.0 M
BEAM:	16' 8" 5.2 M
DRAFT:	5' 1.6 M
AIR DRAFT:	26'5" 8.1 M Mast up, 16'5" 5 M Mast folded
DECK:	White deck with white nonskid
ENGINE	Cummins Engine Model: 6BTA 5.9 280 HP (Hours~ 3,360 July, 2020)
PROPELLER / SHAFT	Dripless shaft seal 4 blade (New August, 2019)
EXHAUST:	Wet exhaust
THRUSTERS:	Side Power 15 HP proportional electric bow and stern thruster
STABILIZATION:	Naiad hydraulic active fin stabilizers
ELECTRICAL:	60 Hertz – US style – 50 amp
SHORE POWER:	50-amp for house and 50-amp air con
GENERATOR:	Onan 12.5 KW generator with Sound Shield (~1,612 hours August, 2019)
INVERTER/CHARGER:	Xantrex 3kW inverter/charger
BATTERIES:	Lifeline (6) AGM House Batteries and Start Battery (New May 2019) New Bow thruster Batteries 2018
INTERIOR LIGHTING:	Low voltage LED lighting upgraded
CLIMATE CONTROL:	Cruisair reverse cycle HVAC: 56,000 BTU (2) compressors
MACHINERY EQUIPMENT:	Reverso oil changer for main, transmission and generator ESI fuel polishing system
WINDLASS:	Muir Cheetah electric windlass with capstan
GROUND TACKLE:	33 KG Rocna anchor with 300' 3/8" HT chain
MAST AND BOOM	Forespar mast and boom for dinghy with electric winch (new lines and cable 2018)
TENDER AND OUTBOARD:	AB 11'5" aluminum - hull inflatable dinghy with 15HP Yamaha 4 stroke with electric start and tilt (new 2016)
NAV/COM BRANDS:	Garmin 7616 in Pilothouse Garmin 7612 Flybridge
ENTERTAINMENT:	Entertainment cabinet in Saloon with new Clarion Bluetooth compatible stereo and 36" Samsung flat screen TV with DirecTV (all new 2018)
STATEROOMS:	2 staterooms (Owner forward, Guest to Port)

Selene 43 Misty Pearl

BEDDING:	Centerline queen (owner) with foam topper and underneath storage Pilothouse watch berth
HEADS:	Two: Jabsco Quiet Flush freshwater toilets (electric freshwater) in owner and guest
SHOWERS:	Two: owner and guest.
LAUNDRY:	Plumbed for combo washer/dryer
GALLEY:	Vitrifrigo 110V/12V refrigerator/freezer (new 2018) Seaward Princess three-burner electric stove and oven with broiler GE Profile microwave oven with exhaust fan
INTERIOR WOOD:	Light Teak
INTERIOR COUNTERS:	Corian counters
INTERIOR UPHOLSTERY:	Ultraleather
INTERIOR FLOORING:	Teak and Holly hardwood
BILGE PUMPS:	Four (4) Rule electric bilge pumps
TANKAGE: (approx.)	
FUEL:	840 gallons 3180 liters
HOLDING BLACK:	40 gallons 151 liters(One fiberglass tank)
FRESH WATER:	300 gallons 1135 liters (Two stainless steel tanks)
SAFETY:	Automatic Engine Room Fire Suppression System (new 2018) USCG safety package Flybridge EPIRB (new 2018) Kidde Halotron 55lb. extinguisher with Engine Room access Engine Room high water alarm
PHOTO DATE:	More photos are due soon
Note: All information is believed accurate but should be verified.	

Misty Pearl truly is a fabulous vessel which will impress you with her stabilized ride while providing ease of service and ownership. She is a proven passage maker built by a manufacturer who has continually evolved in their ability to bring together quality materials, a practical and efficient design and beautiful fit and finish into a package that you will appreciate and take great pride in owning.

Detailed maintenance records confirming pride of ownership are available for review by request*.

You can read all about the cruising accomplishments of the Selene 43 online and by studying magazine reviews and owner blogs. Most of the detail photos of **Misty Pearl** were taken in summer 2019 (many more images are available by request- contact the listing broker*).

Selene 43 Misty Pearl

For additional information please visit Misty Pearl's website, www.Selene43forsale.com

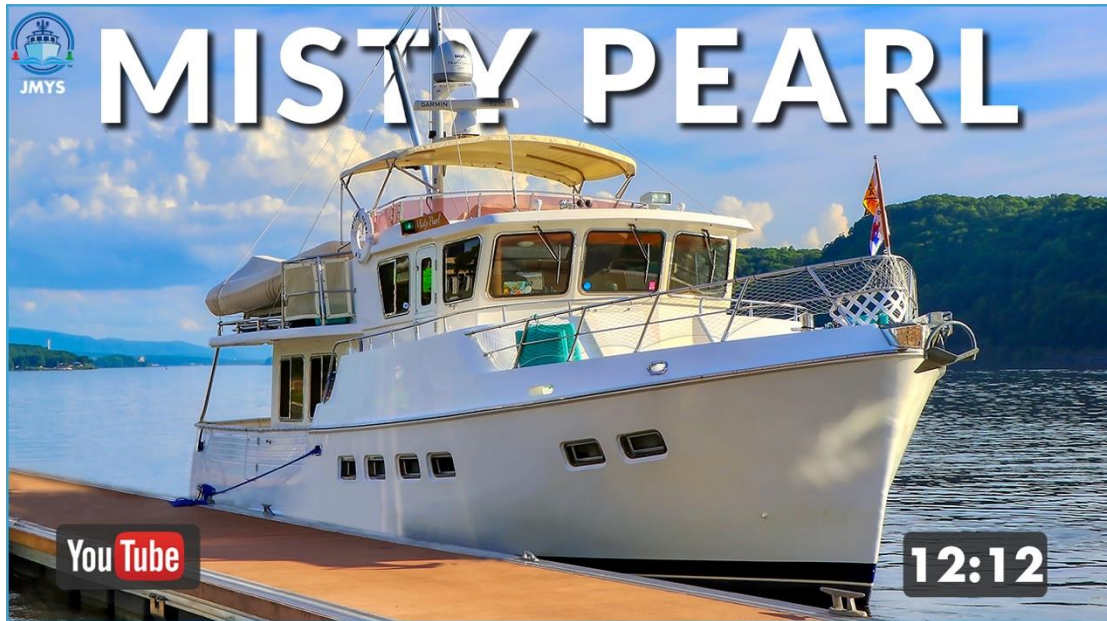

<https://www.youtube.com/watch?v=ku6oUJv-Jy4&t=1s>

Jeff Merrill Yacht Sales, Inc. © 2020 All Rights Reserved www.JMYS.com

Selene 43 Misty Pearl

Exclusions: Potential purchasers should assume that items on the vessel at the time of viewing, but not specifically listed on this sheet, are not included with the sale of the yacht. These specifications are believed to be true and correct but cannot be guaranteed. Items excluded include, but are not limited to Paintings, tools, handheld nav gear and binoculars. Owner's personal effects and clothing will be removed prior to closing.

Disclaimer: Jeff Merrill Yacht Sales, Inc. presents the details of this vessel in good faith but cannot guarantee or warrant the accuracy of this information nor guarantee or warrant the condition of the vessel. Buyers should instruct their agents and their surveyors to investigate all details the buyers desire validated. This vessel is offered subject to prior sale, price change, or withdrawal without notice.

Brokerage: JMYS is a US based (licensed and bonded yacht brokerage in California and Florida) with an international emphasis specializing in ocean capable trawlers. Our brokers are experienced boaters, most are trawler owner/operators with thousands of hours and miles at sea. We treat our clients with respect, we are responsive and not pushy. Our focus is to become your loyal advocate, always looking out for your best interests. The team at JMYS has extensive trawler and motor yacht product knowledge and our skills are available for coaching after the sale has concluded.

Co-Brokerage: Fellow yacht broker association members: This listing is available for co-brokerage and JMYS is a 50/50 house. Courtesy showings are available by appointment. Florida listings subject to appropriate broker licensing required by law.

***Listing broker. Larry Friedman** (licensed Florida Yacht broker) has extensive product knowledge of the trawler market and is a past owner of a Krogen 39. Larry has the advantage of being an owner operator with extensive hands-on experience and can help you from the early stages of the search through purchasing and post purchase coaching. The photos, images and descriptive content are copyrighted by JMYS and may not be copied or used without specific written permission. All inspections are by appointment only. Please contact listing broker, **Larry Friedman** by phone, text or email for additional information or to schedule your personal showing. Larry is always available via Mobile +1.317.501.4671 (call or text). You can send a detailed Email to: Larry@JMYS.com.

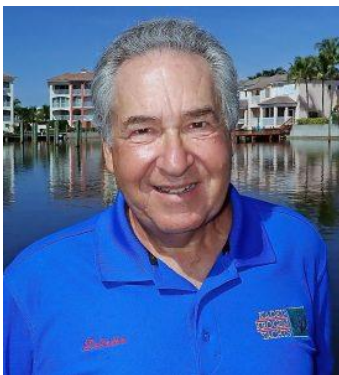

Licensed and Bonded in Florida

International Yacht Brokers Association (Florida)
Yacht Brokers Association of America