

# Seahorse 52 Keokuk



# JMYS

3010 Old Ranch Parkway, Suite 440, Seal Beach, CA 90740  
+1 949.355.4950 | [www.JMYS.com](http://www.JMYS.com)

Jeff Merrill Yacht Sales, Inc. | 3321 SE 14 Avenue | Fort Lauderdale, FL 33316



## *Keokuk*

**Price: \$519,000.00**

**Location: Boyne City, MI**

## Seahorse 52 Keokuk

**Keokuk** is a full displacement, long range passage maker. Her current owner purchased her from the original owner who incorporated several unique features that add to the appearance and simplicity of operation as well as reduced maintenance. If your search has taken you to Nordhavn, Krogen, or Selene it would behoove you to seriously consider this gorgeous 52 foot twin engine trawler. She is equipped with all the same quality brand equipment such as; reliable John Deere 6 cylinder engines, Northern Lights Generator, Garmin plotters, Furuno Radar, etc., in a more affordable package. She is just as easily run from her climate controlled pilothouse as she is from her fully enclosed flybridge. With full 360 degree views, twin screws and bow thruster she can manage tight docking situations as well as any locks, evidenced by her heritage as a two time Great Loop veteran.

As you approach **Keokuk** your attention is immediately drawn to the full custom stainless trim which protects and beautifies the entire combing coupled with additional stainless trim on the transom for added detail and protection. The wide double doors leading into the Saloon from the cockpit make it appear that the outside is inside and vice-versa.

**Keokuk** is an Efficient, Safe and Easy-to-Operate Trawler Built to Go Places and is equally comfortable at rest or at sea. She was designed and outfitted with economical long-range cruising, safe passage making and simplicity of operations in mind. With her twin John Deere engines and extended range fuel tanks totaling 1,000 gallons she has the range to cross oceans and travel the waterways. You can take her to the Bahamas or the Caribbean without worrying about your next fuel stop.

**Keokuk's** design includes a sea-kindly and proven Blaine Seeley hull, a raised Pilothouse with excellent 360 degree visibility, high stainless-steel railings around the entire vessel, commercial grade watertight doors and a protected side deck along the starboard side for safe line handling and forward-aft exterior movement at sea.

**Keokuk** was built in mainland China by Seahorse Marine, an accomplished vessel designer and manufacturer with over 30 years of experience building comfortable, long-range trawlers as well as heavy duty commercial vessels. Seahorse Marine's attention to quality and detail led to their selection as builder of several of the award-winning George Buhler designed Diesel Ducks. She boasts a very practical and truly spacious layout that is beautifully appointed with rich, old world teak joinery, traditional teak and holly flooring and modern touches including: granite countertops, stainless-steel appliances and LED lighting. **Keokuk's** spacious layout is due to the fact that she was designed as a "widebody" Saloon with one side deck to starboard that allows for a much larger middle-level living space (Saloon and Galley). This extra living space, combined with her large windows and aft watertight double doors, provide for a unique indoor-outdoor experience giving her the feel of a beach house or cozy cabin. Her interior volume continues in the professionally equipped Pilothouse, full beam Owner Stateroom, VIP stateroom forward and well-appointed heads... one with a soaking tub!

# Seahorse 52 Keokuk

## DESCRIPTION:

**Keokuk** can be easily and safely boarded from four locations around the vessel, ensuring ease of boarding regardless of the configuration of the docking or mooring situation you find yourself in as you travel from place to place. From the dock you can board **Keokuk** through her hinged boarding gate aft which is molded into the hull on the starboard side. Additionally, **Keokuk** is equipped with two custom stainless-steel boarding gates which allow direct boarding and disembarking of the vessel from/to the dock at the port and starboard Pilothouse doors. And finally, she features a folding stainless-steel boarding gate astern which allows direct access from the water onto the integrated swim step and into the Cockpit through a hinged door molded into the transom.

Cockpit: The Cockpit, aft of the Saloon, is a popular hangout area with room for outdoor chairs. The Cockpit is protected by the Boat Deck overhang which provides shade for relaxing whether in port, at anchor or underway on fair days and shelter from sun and rain. From the Cockpit, the entry to the Saloon is impressive, with two hinged opening doors and windows that really open this space up and merges the indoor and outdoor living space into one large, airy room.

Saloon: Inside the Saloon to port there is a large U shaped settee and table. For additional seating there is also a custom oval bench which can be used as an Ottoman for the built-in curved settee to starboard. This oval bench doubles as a coffee table, Ottoman, or dining table for two. The view from the Saloon is magnificent with large sliding windows outboard and aft, providing a feeling of openness with excellent all-around visibility and air flow. **Keokuk** is an all-weather cruiser with a robust Hurricane diesel furnace for cold winter days and dual Cruisair reverse cycle HVAC providing 32,000 BTU's to keep you cool on the hottest of days.

Galley: The Galley is forward to port, spacious and integrated with the Saloon, but separated by attractive, granite counters. In the Galley you will find stainless appliances including a Nova Kool standup refrigerator/freezer, Broadwater (4) burner propane stove, GE Profile Convection/Microwave and Uline under the counter ice maker. There is also a GE trash compactor and a fabulous custom fold down teak dish rack. Over the stove is an Ariston hood with integrated fan and external exhaust. In addition, the Galley features plenty of counter space and teak storage cabinets making it suitable for planning and preparing excellent meals.

Across from the Galley is Splendide washer/dryer and an integrated entertainment center which houses the 26" Samsung TV with DirecTV, all new in 2018. The entertainment center is also finished in a granite countertop carrying on the theme from the Galley. Finally, there is the central vacuum system, to keep her ship shape and tidy without the need to store a vacuum on board. Forward of the entertainment center on the starboard side is the custom wine locker to insure safe transit of your favorite Pinot Noir or Sauvignon Blanc.

Pilothouse: Moving forward from the Saloon is another of **Keokuk's** key features for safe, all-weather, around the clock cruising: a raised, well protected, professionally appointed Pilothouse featuring a curved settee with teak table, a freezer underneath, and a Stidd Helm Chair. For ease of moving around the Pilothouse, the table folds using a custom piano hinge. It's very smart and is just one more example of the thoughtful design features built into **Keokuk**.

# Seahorse 52 Keokuk

The current owners further enhanced the Pilothouse with both professional and pleasurable cruising in mind. The look of the Pilothouse is all business with its traditional teak helm, custom leather chair, raked back forward windows, watertight Dutch doors and chart table with storage for charts underneath.

**Keokuk's** navigation system is run by an upgraded Garmin 7612 plotter, and Furuno radar backed up by Furuno NavNET with C-MAP integration. Add in dual engine controls, dual Flo Scan fuel burn gauges, rear mounted camera, tank monitoring panel, VHF radio, spotlight control and you have the Pilothouse professionals appreciate and EVERYONE loves to be in!

Staterooms: From the Pilothouse, moving forward down a curved stairway with teak safety rails, you reach a landing that allows you to move forward and aft. Moving aft you enter the midship Owner Stateroom with centerline queen bed. Anyone who has traveled on a trawler knows that the closer to the center of the boat, the more stable the ride. This full width stateroom also has a built in desk to port as well as a comfy built in love seat with large opening porthole above for light and ventilation. The head and tub shower are en suite to port and both heads feature high end stainless faucets and granite countertops. Forward you pass the Guest Head with full shower to starboard and then enter the Guest Stateroom up front which also features a centerline queen berth and a pair of full length hanging lockers.

Engine Room: The Engine Room and Generator/Electrical/Battery Room are located below the Saloon with two through-floor entries. A smaller hatch aft in the Saloon leads directly to the Generator/Battery Room and a long lifting hatch further forward in the Saloon leads directly to the Engine Room ... both rooms are also connected via a small connecting door with viewing port.

The Engine Room, which features twin John Deere 6068TFM marine diesel engines and Twin Disc ZF transmissions, is arranged for easy service and inspection of all primary machinery and fuel filters from directly below the entry. All serviceable items are chest level for ease of access, particularly important when checking the engine or changing fuel filters underway. The Racor filters are logically located on the forward bulkhead for ease of operation and maintenance. Sea water for the engine, generator, watermaker and water heater is provided by a very practical Sea Chest. The water heater, Hurricane heating system, Reverso automatic oil changer and other equipment are mounted around the Generator Room are easily accessible. There are five (5) fiberglass fuel tanks holding 1,000 gallons of diesel fuel that enable you to go nonstop for days at a time, and a robust fuel transfer system for fuel transferring and easy movement of fuel from tank to tank if needed.

**Keokuk** is outfitted with a powerful and reliable Northern Lights generator which provides AC power whenever you need it. The dedicated Generator start battery was replaced in 2020 as were all the house batteries and start batteries. The batteries and generator are complemented with a Magnum 2500 inverter and Xantrex charger which provides another source of AC power (via the house batteries) and automatically charges all batteries as needed. This room also has space for stowage of tools and other repair/maintenance items.

## Foredeck:

The entire outside deck area is protected by tall stainless-steel railings making it safer for moving about. On the Foredeck, just below the forward Pilothouse windows, is a bench seat for relaxing and enjoying the view and large storage lockers that house the propane tanks with plenty of room for fenders, lines and other deck-related gear. Further forward, the Foredeck is smooth and uncluttered with the windlass

# Seahorse 52 Keokuk

and ground tackle up front including foot pedals for lowering and raising the anchor without the need to be in the Pilothouse. Using the ground tackle set up on the Foredeck and the Muir windlass controls in the Pilothouse or the Flybridge makes anchoring **Keokuk** straightforward and stress free, even singlehanded.

From the Foredeck, walking aft to port, you go up a couple of fiberglass steps to arrive at the Boat Deck. This area has a stainless davit with electric hoist for easily launching and retrieving the 9'6" Zodiac propelled by an efficient Yamaha 6 HP, 4 stroke outboard. Noteworthy is the stainless hinge and struts at the base of the folding mast making this boat Great Loop friendly when you need to lower her profile.

Cockpit: The Aft Deck is roomy and contains moveable seating. A transom door provides access to the integrated swim platform which has built in storage and a hot and cold shower for rinsing off or showering.

**Keokuk** is in excellent condition. Starting anew every owner has a choice in how they look after their charge. The current owner of **Keokuk** started with a gem and continue to polish her. She resides in the clear fresh waters of Lake Charlevoix just off Lake Michigan. The owners understand the importance of caring for their equipment so that it will care for you. This priority of maintenance ensures **Keokuk** is always ready for departure and will be a dependable cruising platform.

The equipment installed throughout **Keokuk** includes many top name-brand selections any long-term cruiser would desire, ensuring the vessel is reliable, safe, comfortable, efficient, and easy to operate.

**LAYOUT:** Flybridge

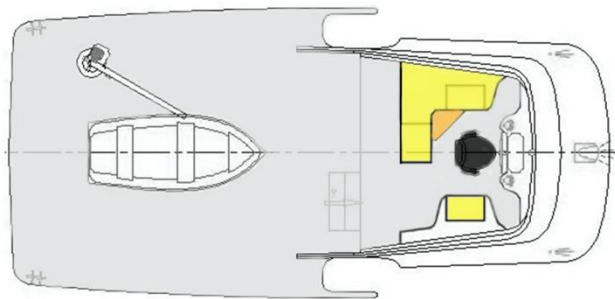

# Seahorse 52 Keokuk

**LAYOUT:** Saloon, Galley, and Pilothouse

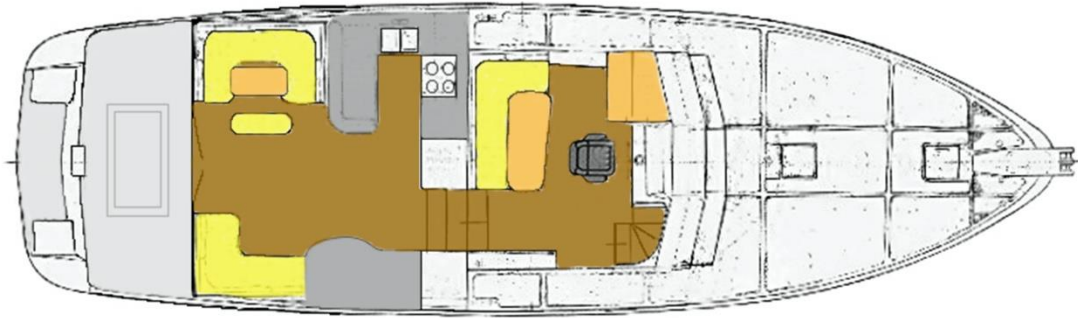

**LAYOUT:** Staterooms and heads

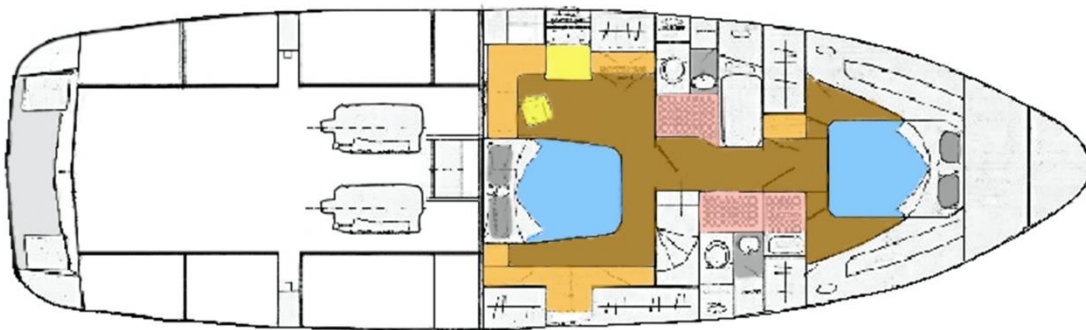

# Seahorse 52 Keokuk

**SPECIFICATIONS:**

<b>YACHT NAME:</b>	<i>Keokuk</i>
<b>BRAND AND MODEL:</b>	Seahorse 52
<b>TYPE:</b>	Long range trawler yacht with raised pilothouse and Flybridge
<b>LOCATION:</b>	Boyne City, Michigan
<b>MODEL YEAR:</b>	2005
<b>HULL NUMBER:</b>	14
<b>HULL COLOR:</b>	White Awlgrip
<b>REGISTRY:</b>	United States Coast Guard documented
<b>DESIGNER:</b>	Blaine Seeley
<b>BUILDER:</b>	Seahorse Marine
<b>HULL MATERIAL:</b>	Solid fiberglass
<b>DISPLACEMENT:</b>	62,000 lbs.   28 metric tons
<b>SPEED:</b>	Cruise 8.5 knots @1400 RPM. Top 11 knots @ 2350 RPM
<b>LOA:</b>	52'0"   15.85 M
<b>LWL:</b>	46'2"   14.07 M
<b>BEAM:</b>	15'0"   4.57 M
<b>DRAFT:</b>	4'6"   1.37M
<b>AIR DRAFT:</b>	Mast up 26'0"   7.92M, Bimini up 18'8"   5.69 M, Mast and Bimini down 16'0"   4.88 M
<b>DECK:</b>	White deck with white nonskid
<b>ENGINES</b>	(2) John Deere 6068 6.8L 175HP Turbo (Hours ~ 2,130 July, 2020)
<b>TRANSMISSIONS</b>	ZF Straight HSW630A1   2.5:1 reduction
<b>BURN RATE</b>	(2) Flo Scans   Average cruise is 1450 rpm using two MPG at a speed over ground of 8 knots
<b>PROPELLER / SHAFT</b>	(2) 2.25 stainless shafts with PSS dripless seals   (4) bladed 28" x 25.5"   711mm x 648 mm
<b>EXHAUST:</b>	Wet exhaust
<b>SEA WATER INTAKE</b>	12" x 36" Sea Chest
<b>THRUSTER:</b>	Side Power 10 HP proportional electric bow thruster
<b>STABILIZATION:</b>	None
<b>ELECTRICAL:</b>	60 Hertz – US style – 50-amp, Also set up for single 30 AMP

## Seahorse 52 Keokuk

<b>SHORE POWER:</b>	50-amp for house and 50-amp air con /30 Amp
<b>GENERATOR:</b>	Northern Lights 12kW M843Nk.3
<b>INVERTER/CHARGER:</b>	Magnum Inverter   Xantrex Charger
<b>BATTERIES:</b>	(4) AGM House Batteries and (2) AGM Start Batteries (New May 2020)   (1) AGM Bow thruster Battery   (1) AGM Start for Generator
<b>INTERIOR LIGHTING:</b>	Low voltage LED lighting upgraded
<b>CLIMATE CONTROL:</b>	Cruisair reverse cycle HVAC: 16,000 BTU x (3) compressors   Diesel Heat - Hurricane
<b>MACHINERY EQUIPMENT:</b>	Reverso oil changer for main and generator   ESI fuel polishing system
<b>WINDLASS:</b>	Muir Cheetah electric with remote in Pilothouse and Flybridge
<b>GROUND TACKLE:</b>	Primary anchor Rocna stainless 73 lbs./ 33 Kg   Bruce stainless plow 66 lbs. / 30 Kg
<b>MAST</b>	Fiberglass mast with hinged base and stainless steel lowering struts
<b>TENDER AND OUTBOARD:</b>	Zodiac 9'6" RIB with Yamaha 6HP 4-stroke outboard
<b>NAV/COM BRANDS:</b>	Furuno, Icom, Garmin
<b>ENTERTAINMENT:</b>	Intellian Satellite   26" TV in Saloon (new 2018)   13" TV with DVD in Owner   Niles/Sony sound system with 12 remote speakers throughout the vessel
<b>STATEROOMS:</b>	(2) staterooms (Owner Stateroom amidships centerline and VIP Guest forward)
<b>BEDDING:</b>	Centerline queen (Owner) with foam topper
<b>HEADS:</b>	Two: Vacuflush freshwater toilets (electric freshwater) in Owner stateroom ensuite and forward for Guest stateroom
<b>SHOWERS:</b>	(3) Owner with Tub   Day Head/Guest head   Transom outdoor
<b>LAUNDRY:</b>	Splendide Combo (not vented)
<b>GALLEY:</b>	Broadwater 4 Burner LP stove and oven   Nova Kool refrigerator/freezer - Nova Kool   GE Profile microwave convection oven   Double basin stainless sink   Uline ice maker   GE trash compactor
<b>VACUUM</b>	Central vacuum throughout the boat



## Seahorse 52 Keokuk

<b>EXTERIOR TRIM</b>	Custom stainless trim on combings around entire vessel and on Transom
<b>INTERIOR WOOD:</b>	Light Teak
<b>INTERIOR COUNTERS:</b>	Granite
<b>INTERIOR UPHOLSTERY:</b>	Ultraleather
<b>INTERIOR FLOORING:</b>	Teak and Holly hardwood
<b>BILGE PUMPS:</b>	(4) Rule electric bilge pumps
<b>TANKAGE:</b> (approx.)	
<b>FUEL:</b>	(4) primary plus (1) day tank 1,000 Gallons / 3,785 L – (fiberglass)
<b>HOLDING BLACK:</b>	50 Gallons / 189 L (fiberglass)
<b>FRESH WATER:</b>	200 Gallons   757 L (2 fiberglass tanks) + tank for Watermaker
<b>SAFETY:</b>	Fireboy Xintex fire suppression system in Engine Room and in Generator room which provides protection for engine, generator, and diesel heat system (2015)  Fire extinguishers throughout the vessel (6) A/B/C conforming   (2) #11 safe agent handheld.
<b>PHOTO DATE:</b>	July 2020
<b>Note: All information is believed accurate but should be verified.</b>	

## Seahorse 52 Keokuk

This description has been created to encourage you to call. There is much more to discover, and as you now know, she is marvelously equipped. Your next move is to connect and make an appointment so that you can step aboard to see for yourself...*Keokuk*.



For additional information please visit *Keokuk's* website, [www.Seahorse52ForSale.com](http://www.Seahorse52ForSale.com)

**Exclusions:** Potential purchasers should assume that items on the vessel at the time of viewing, but not specifically listed on this sheet, are not included with the sale of the yacht. These specifications are believed to be true and correct but cannot be guaranteed. Items excluded include, but are not limited to paintings, tools, handheld nav gear and binoculars. Owner's personal effects and clothing will be removed prior to closing.

**Disclaimer:** Jeff Merrill Yacht Sales, Inc. presents the details of this vessel in good faith but cannot guarantee or warrant the accuracy of this information nor guarantee or warrant the condition of the vessel. Buyers should instruct their agents and their surveyors to investigate all details the buyers desire validated. This vessel is offered subject to prior sale, price change, or withdrawal without notice.

## Seahorse 52 Keokuk

**Brokerage:** JMYS is a US based (licensed and bonded yacht brokerage in California, Florida and Washington) with an international emphasis specializing in ocean capable trawlers. Our brokers are experienced boaters, most are trawler owner/operators with thousands of hours and miles at sea. We treat our clients with respect, we are responsive and not pushy. Our focus is to become your loyal advocate, always looking out for your best interests. The team at JMYS has extensive trawler and motor yacht product knowledge and our experience is available for coaching after the sale has concluded.

**Co-Brokerage:** Fellow yacht broker association members: This listing is available for co-brokerage and JMYS is a 50/50 house. Courtesy showings are available by appointment. Florida listings subject to appropriate broker licensing required by law.

**\*Listing broker. Larry Friedman** (licensed Florida Yacht broker) has extensive product knowledge of the trawler market and is a past owner of a Kadey-Krogen 39. Larry has the advantage of being an owner operator with extensive hands-on experience and can help you from the early stages of the search through purchasing and post purchase coaching. The photos, images and descriptive content are copyrighted by JMYS and may not be copied or used without specific written permission. All inspections are by appointment only. Please contact listing broker, **Larry Friedman** by phone, text or email for additional information or to schedule your personal showing. Larry is always available via Mobile +1.317.501.4671 (call or text). You can send a detailed Email to: [Larry@JMYS.com](mailto:Larry@JMYS.com).

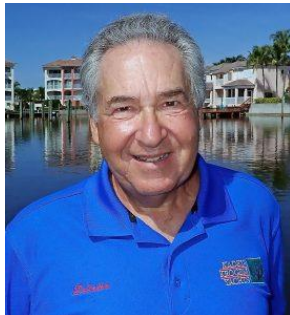

**Licensed and Bonded in Florida**

International Yacht Brokers Association (Florida)

Yacht Brokers Association of America