

Selene 57 High Spirit



JMYS

3010 Old Ranch Parkway, Suite 440, Seal Beach, CA 90740
+1 949.355.4950 | www.JMYS.com

Jeff Merrill Yacht Sales, Inc. | 3321 SE 14 Avenue | Fort Lauderdale, FL 33316



High Spirit

Asking: \$859,000

Location: Charleston, SC

Selene yachts has been building and designing ocean going passagemakers for over 20 years. Today over 400 *Selene* trawlers are cruising the oceans. *Selene* trawlers are known for their graceful and elegant lines, beautiful teak interiors, top notch craftsmanship and stout full displacement hulls. *High Spirit* carries on this tradition in fine style. Her current owners have carefully upgraded and improved her to meet their own high standards.

Selene 57 High Spirit

High Spirit has not been left tied up at the dock like so many boats, but rather she has been busy cruising up and down the U. S. East coast. From Halifax, Nova Scotia down to the Virgin Islands and the Dominican Republic, she is a well-traveled trawler.

High Spirit is well equipped with numerous systems to take you to your destination in comfort and safety. Improvements in the last two years include a hull paint job, new upholstery, new galley refrigerator/freezer, new laundry appliances, a new water maker and more! Redundant electronics assist with navigating. Bow and stern thrusters as well as active fin stabilizers help with handling and provide a more comfortable ride. A close review of her equipment selections will show you she has been outfitted for long ranging adventures. A full-time captain is aboard to look after and care for her, keeping her fresh, active and raring to go. She is even equipped with a wing/get home engine, not a common option on a **Selene**. Whether your plans include coastal or long-range cruising, **High Spirit** will take you there in style.

DESCRIPTION:

Cockpit: You can board **High Spirit** from fore or aft entry doors on port and starboard or via the swim deck and transom door. The cockpit is huge and covered overhead. You will notice natural teak decking that extends to the side decks on both sides of the saloon. On a hot afternoon you can enjoy a cold beverage sitting in a comfortable settee with your glass perched on the beautifully finished teak table. The cockpit is surrounded by a gorgeous teak cap rail that adds to her beauty. Forward on the port side is a storage cabinet with a large countertop.

- Custom build, adjustable teak table
- Built-in settee
- Built-in storage cabinet with counters, drawers and teak trim
- 50 AMP Shore power and TV/Phone/Cable connectors
- Diesel fuel fills and vents
- Hawes pipes with cleat horns
- Starboard, port and transom entry doors
- Hot/cold freshwater shower
- Built-in swim ladder on the swim deck
- (2) "U" shaped removable stanchions on swim step
- Custom covers for cap rail, settee and table
- Opening hatch to the lazarette

Saloon: From the cockpit you enter the saloon through a commercial grade, water tight Dutch door. Once you enter the saloon you get a feel for how spacious this boat is and you get a first glance of the gorgeous teak wood interior. On the starboard side you have a long settee with storage cabinets on either side and drawers underneath. On the port side is a large, comfortable L-shaped settee with a beautifully finished teak, high/low dining table in front. The interior has a sunny, warm feeling due to the large

Selene 57 High Spirit

opening windows that provide great visibility and ventilation. Forward is the galley counter with a flat screen TV built in.

- Diamond Sea Glaze, watertight Dutch door
- Large opening windows on both sides
- Accent curtains at all windows
- Teak shades on all windows
- L-shaped settee on port side
- Long settee on starboard side with storage drawers underneath
- Entertainment equipment storage cabinet, aft starboard side
- Climate controls
- Adjustable high/low table
- Cantalupi lights overhead
- Teak handrails overhead
- Alpine CD/DVD player
- KVH TracVision system
- LG 27" flat screen TV
- Access hatch to engine room below
- House battery disconnect switches - under L-shaped settee
- Locking pin to secure lazarette hatch

Galley: As you move forward from the saloon you enter a large U-shaped galley on the port side. The galley has plenty of counter space, with a large granite bar/breakfast counter on top and a Corian counter below. There are plenty of storage lockers and drawers throughout. The galley is equipped with the necessary appliances. The original refrigerator/freezer has been replaced with new stainless steel Vitrifrigo refrigerator. On the starboard side a stairway leads down to the owner stateroom and to the main access door of the engine room. Or, you can go up a few steps to the pilothouse.

- Granite bar counter
- Corian work counter below
- Double basin stainless steel sink
- Vitrifrigo refrigerator and freezer

Selene 57 High Spirit

- GE convection/microwave oven
- Force 10 (3) burner stove/oven
- Custom dish and glass storage
- Built-in pantry storage drawers
- Additional storage compartment built-in below the counter, next to the stove
- Multiple storage cabinets and drawers below the counter
- Stairway down to the owner stateroom and engine room on starboard side

Pilothouse: As you leave the galley you go up a couple of steps to the pilothouse. On the port side there is a small storage locker and a brand new, built in Vitrifrigo ice maker. The pilothouse on **High Spirit** is very spacious, with tremendous visibility. The reverse raked windows and the Portuguese bridge in front give **Selene** trawlers that old time salty look they are famous for. Aft is a large L-shaped settee and a custom teak table. A pilot berth is up and behind the settee. At the helm you have a comfortable Stidd chair with all electronics and engine controls easily accessible and visible right in front of you. You have easy access to the side decks and the Portuguese bridge through the watertight Dutch doors on either side. A companion way leads up to the flybridge and a stairway on the starboard side leads down to the cabins.

- Leather Stidd helm chair
- Wooden helm wheel
- Expandable chart table
- Reverse raked pilot house windows
- (3) 24V windshield wipers with washers
- (2) Diamond Sea Glaze Dutch watertight doors (with teak interior panels)
- Built-in Vitrifrigo ice maker in the companionway to the galley
- Cantalupi lights overhead
- Climate controls
- Selene 57 Safety Panel overhead
- Yanmar Wing Engine controls and gauges overhead
- Brass ship's clock and barometer
- 24v/120V/230V Breaker panel behind a glass door
- House battery disconnect switch
- Inverter disconnect switch

Selene 57 High Spirit

- Hurricane heater controls
- Norther Lights generator control panel and gauges
- High water alarm
- Garmin GPSmap XSV Chartplotter/MFD
- (2) Raymarine Pathfinder RL80C GPS/Chartplotter/Radar
- Raymarine DS600X fishfinder
- Raymarine ST60 Tridata MFD
- Raymarine ST60 Wind instrument display
- Raymarine GPS RH300 GPS
- Raymarine ST8001 autopilot
- (2) Maxwell AA500C windlass controllers/chain counters - (inoperable)
- Racor fuel water separator alarms for main, wing and generator filters
- Icom VHF Marine IC-M602 Radio
- Icom HF Marine IC-M802 SSB Radio
- Xantrex Link 2000 inverter/charger control panel
- Naiad active fin stabilizer control panel
- VDO rudder angle indicator
- 5" Danforth Constellation compass
- Sidepower Bow and Stern thruster joysticks and controls
- L-shaped settee and table
- Pilot berth behind the settee (extends inboard for longer bunk)

VIP Cabin: Going down the stairs from the pilot house on the starboard side you reach the lower level and then forward to the VIP cabin. This cabin is fit for any VIP with a large, walk-around bed on center-line, cedar lined hanging lockers and plenty of storage space throughout. This cabin also has lots of light and ventilation thanks to four opening port lights and an opening hatch overhead. Just outside the entry door on the starboard side is the head which is also shared with the second guest cabin. The head is spacious with a standup shower stall and a freshwater Tecma toilet.

- Centerline Queen size berth
- (2) large, cedar lined hanging lockers

Selene 57 High Spirit

- Numerous lockers and drawers
- (4) Round, opening port lights
- Overhead hatch
- (2) Night lights
- Cantalupi lights overhead
- Insignia 24" Flat Screen TV
- A head shared with VIP and guest cabin is aft and starboard
- Tecma fresh water toilet
- Standup shower stall
- (2) large opening port lights in the head

Guest Cabin: Going aft from the VIP cabin on the port side is the second guest cabin which can also be used as a functional office. It has two stacked bunks - one athwartship and the other is positioned fore and aft. A built in desk and chair make it a nice work space. Two opening port lights provide light and ventilation to this cozy cabin.

- Two bunk beds (one athwartship, the other fore/aft)
- Built-in desk
- Custom Selene office chair
- (2) large opening port lights
- Large hanging locker, overhead cabinets and book shelf

Owner Stateroom: Going aft in the companionway landing you enter the spacious Owner Stateroom with its queen sized island berth easily accessible on both sides and built in nightstands. This cabin has a tremendous amount of storage space with hanging lockers and drawers throughout. The port side has a built in dresser with a large counter on top and two extra-large port lights providing light and ventilation. The head is on the starboard side, with granite tile floors, a spacious standup shower stall and a freshwater Tecma toilet. On the starboard side and aft you have a private stairway going up to the saloon and the main access door to the engine room.

- Queen sized berth
- (2) Night stands
- Climate controls
- Built-in dresser
- (2) large opening port lights

Selene 57 High Spirit

- LG 27" Flat Screen TV
- Cantalupi lights overhead
- (2) Night Lights
- (3) Cedar lined hanging lockers
- Storage lockers and drawers throughout the cabin
- Ensuite head and shower stall
- Tecma fresh water toilet
- (2) Large opening port lights

Engine Room: The engine room is under the saloon and galley. It is accessible via watertight doors from the owner stateroom or from the lazarette. There is also a large hatch door in the saloon floor providing additional access. The engine room is very well organized, with all of the machinery easily accessible. The Cummins main engine and the Yanmar wing engine are easily serviceable from all sides. Northern Lights generator is aft inside of a sound enclosure. Dedicated Dual Racor fuel filters provide clean fuel to the main engine, wing engine and the generator. For an additional level of fuel filtration **High Spirit** is equipped with the ESI fuel polishing system. All of the start batteries and the tool chest are accessible on the port side. Going aft you can enter the lazarette through a small watertight door.

- Cummins QSM-11M main engine
- Yanmar 4JH4E wing engine
- Northern Lights M843NW – 12kW generator
- Dual Racor fuel filters for main engine, wing engine and generator
- ESI Fuel polishing system and transfer pump
- Fireboy fire suppression system
- Reverso oil change system for main engine, wing engine and generator
- Hynautic engine controls
- Torrid 20 Gallon water heater
- PSS dripless shaft seal
- Balmar 220-amp alternator

Lazarette: This area can be accessed from the engine room or from a large overhead hatch in the cockpit. The lazarette houses recently replaced, full sized clothes washer and dryer. This is also where the large Grunert freezer, Glendinning shore power cord retriever and the water maker are located. The Hurricane diesel hot water heating system is installed aft to starboard. There is lots of storage space including a small work area with a vise.

Selene 57 High Spirit

- Grunert freezer
- Glendinning shore power cord storage
- Spectra Blue Water Express water maker
- Hurricane diesel hot water heating system
- Asko clothes washer and Ignis clothes dryer
- Work counter and vise
- Access ladder up to cockpit
- Extra anchor

Flybridge: The flybridge is the place to be on this yacht. The visibility is unsurpassed and there is plenty of space to entertain your guests. The upper helm has all of the controls that you expect, including two helm chairs that are a pleasure to sit in. On the port side you have a comfortable L-shaped settee with a large table. The starboard side has storage cabinets, a large BBQ grill and a small sink.

- (2) Pompanette helm chairs
- Raymarine RL80C GPS/Chartplotter/Radar display
- Icom VHF Marine IC-M602 VHF radio
- Raymarine ST60 multipurpose display
- Raymarine autopilot remote
- VDO rudder angle indicator
- Cummins LCD engine monitor
- Danforth Constellation compass
- (2) Maxwell AA500C anchor windlass controllers/chain counters - (inoperable)
- Hynautic controls for main engine
- Stainless steel propane BBQ grill
- Stainless steel sink
- Bimini top and custom stainless-steel frame
- L-shaped settee and table

Boat Deck: The boat deck aft has the RIB dinghy on the starboard side and an Aritex hydraulic davit used to deploy it. On the port side and forward are two large storage boxes. Upon deploying the dinghy, the boat deck on **High Spirit** opens up to a large space that can be used for entertaining guests or just enjoying the outside.

Selene 57 High Spirit

- Aritex hydraulic dinghy davit
- Avon SE360 Seasport dinghy with a 40hp Yamaha four stroke outboard
- Two large storage boxes
- Viking 6-person life raft
- Fixed chocks for the dinghy
- Stainless steel railing around the entire boat deck for safety

Foredeck: The foredeck is surrounded by stainless steel rails for on-deck safety. Ideal horizontal windlass is mounted with two anchors and assorted ground tackle available and at the ready. A large stainless-steel Sampson post is mounted aft of the windlass. The decking is Moon Dust Awlgrip non-skid. There are two separate very large chain lockers, large enough to store additional ground tackle or fenders. Forward shore power and chain wash down connections are easily accessible. Aft is a comfortable settee built into the Portuguese bridge.

- Ideal horizontal windlass
- 105 lb. CQR anchor with 300 ft. of 1/2" chain
- 66 lb. Bruce anchor with 300 ft. of 1/2" chain
- Stainless Steel Sampson Post
- Two chain lockers
- Windlass foot controls
- Fresh and salt water wash down faucets
- 50 AMP Shore power and TV/Phone/Cable connectors
- Settee mounted into the Portuguese bridge
- Hawes pipes with cleat horns

SPECIFICATIONS:

YACHT NAME:	High Spirit
BRAND AND MODEL:	Selene 57
TYPE:	Raised pilothouse, flybridge, full displacement
LOCATION:	Charleston, SC

Selene 57 High Spirit

MODEL YEAR:	2005
HULL NUMBER:	21
HULL COLOR:	Awlgrip Flag Blue
REGISTRY:	Canadian Registry. US Duty Paid.
DESIGNER:	Howard Chen
BUILDER:	Jet Tern Marine
HULL MATERIAL:	Solid fiberglass
DISPLACEMENT:	102,000 lbs. 46.27 MT
SPEED:	Cruise 9 Knots @ 1,810 RPM Top 10.5 Knots @ 2,100 RPM
LOA:	63'2" 19.25 M
BEAM:	17'2" 5.23 M
DRAFT:	5'9" 1.75 M
AIR DRAFT:	21'6" 6.55 M with antennas down
DECK:	Moondust Awlgrip non-skid on foredeck and boat deck Teak in cockpit and side decks
MAIN ENGINE:	Cummins QSM11-M 450 HP ~4,680 hours September 2020
TRANSMISSION:	ZF-325-1A 2.417:1 ratio
PROPELLER / SHAFT:	Shaft - 3" Stainless Four blade propeller 38" x 23.5" LH PSS shaft seal
WING ENGINE:	Yanmar 4JH4E 56 HP Direct drive ~65 hours September 2020
STABILIZERS:	Naiad 24V VDC Datum active fin stabilizers – 7 sq. ft. fins
THRUSTERS:	SidePower SP155TC - 24V bow and stern thrusters
ELECTRICAL:	60 Hertz – US style - 110V 50-amp AC 24V DC
SHORE POWER:	50-amp shore power (forward and aft connections)
GENERATOR:	Northern Lights M843NW 12kW - 120/240V ~5,220 hours September 2020
INVERTER/CHARGER:	Heart Freedom Inverter/Charger - 2500-watt inverter with bypass Dolphin 12-20 and Dolphin 24-100 Chargers

Selene 57 High Spirit

BATTERIES:	House (4) - 4D AGM New 9/2020 Start (3) - Engine/Gen/Wing - 2018 (2) each - Bow/Stern thrusters - 2017
INTERIOR LIGHTING:	Cantalupi overhead lights
WATER MAKER:	Spectra Bluewater Express - 40 gallons/hour - New 2019
CLIMATE CONTROL:	Cruisair Reverse Cycle AC/Heat 64,000 BTU System Hurricane Diesel Heating System
MACHINERY EQUIPMENT:	Dual Racor fuel filter systems ESI Fuel Polishing system Grunert freezer Reverso oil change system Balmar 24V/220 Amp auxiliary alternator
WINDLASS:	Ideal 24V - Horizontal - (2) gypsy chainwheels for rode / (1) line capstan center top
GROUND TACKLE:	105 lb. CQR anchor and 300 ft. 1/2" chain 66 lb. Bruce anchor and 300 ft. 1/2" chain
CRANE:	Aritex hydraulic dinghy crane
TENDER AND OUTBOARD:	Avon SE360 Seasport 40 HP Yamaha four stroke outboard
NAV/COM BRANDS:	Raymarine Icom Garmin
ENTERTAINMENT:	LG 27" TV in saloon LG 27" TV in owner Insignia 24" TV in VIP Alpine DVD/CD/AM/FM Control Head Speakers in cabins and flybridge SAT TV - KVH HD7 TracVision antenna
STATEROOMS:	(3) Owner aft, VIP guest cabin forward, Bunk room/office to port
BEDDING:	Custom bedding throughout
HEADS:	(2) TECMA - electric freshwater
SHOWERS:	(3) - Owner - stall Guest - stall Cockpit
LAUNDRY:	Asko clothes washer Ignis clothes dryer (New 2019) both located in the lazarette
GALLEY:	Force 10 3-burner propane stove and oven Vitrifrigo refrigerator/freezer (new 2018) GE convection microwave oven Granite/Corian counters Scandvik double stainless-steel sink
INTERIOR WOOD:	Teak - Satin finish
INTERIOR COUNTERS:	Granite and Corian counters
INTERIOR UPHOLSTERY:	Cloth upholstery (most new 2018)
INTERIOR FLOORING:	Teak and holly soles Granite tile head soles Carpet

Selene 57 High Spirit

BILGE PUMPS:	(4) Electric automatic (1) High water alarm (1) Hand operated pump (2) Shower sump pumps
TANKAGE: (approx.)	
FUEL:	1,500 gallons 5,678 L (Two fiberglass tanks)
HOLDING BLACK:	70 gallons 265 L (One fiberglass tank)
FRESH WATER:	480 gallons 1817 L (Two fiberglass tanks)
ADDITIONAL EQUIPMENT:	Vitrifrigo Ice Maker in the pilothouse Fireboy fire system in the engine room ACR search light Engine room and boat deck cameras Flybridge - covered stainless steel sink Flybridge - covered propane BBQ New 2018 exterior covers and Bimini Kahlenberg air horn Stidd helm chair in the pilothouse
SAFETY:	(5) Fire extinguishers (13) Life jackets Viking 6 Person Life raft - exp. Jan/2022
PHOTO DATE:	Most detail photos were taken in September, 2020
Note: All information is believed accurate but should be verified.	

Selene 57 High Spirit

LAYOUT: Upper Deck - Flybridge

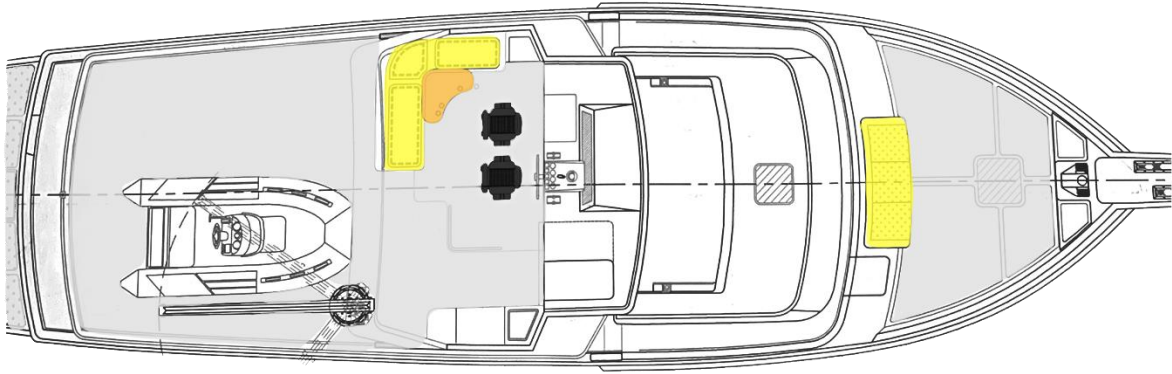

LAYOUT: Main Deck – Saloon, Galley and Pilothouse (note: there is a watch berth)



LAYOUT: Lower Deck – Engine Room, Staterooms, Heads

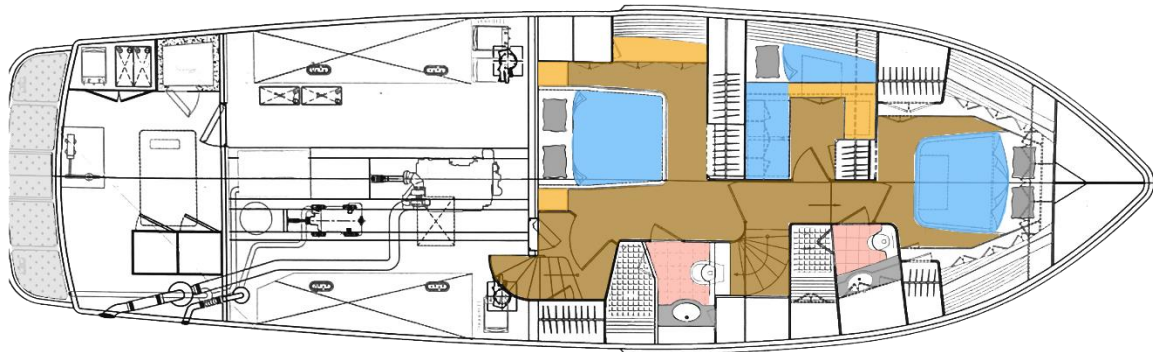

Selene 57 High Spirit

For additional information please visit the High Spirit website, www.Selene57ForSale.com

Please watch our YouTube video: Link: <https://www.youtube.com/watch?v=2KzKzIqRHo4>



The detail photos of *High Spirit* were taken in September of 2020 (many more images are available by request- contact the listing brokers*).



Selene 57 High Spirit

Exclusions: Potential purchasers should assume that items on the vessel at the time of viewing, but not specifically listed on this sheet, are not included with the sale of the yacht. These specifications are believed to be true and correct but cannot be guaranteed. Items excluded include, but are not limited to Paintings, tools, handheld nav gear and binoculars. Owner's personal effects and clothing will be removed prior to closing.

Disclaimer: Jeff Merrill Yacht Sales, Inc. presents the details of this vessel in good faith but cannot guarantee or warrant the accuracy of this information nor guarantee or warrant the condition of the vessel. Buyers should instruct their agents and their surveyors to investigate all details the buyers desire validated. This vessel is offered subject to prior sale, price change, or withdrawal without notice.

Brokerage: JMYS is a US based (licensed and bonded yacht brokerage in California and Florida) with an international emphasis specializing in ocean capable trawlers. Our brokers are experienced boaters, most are trawler owner/operators with thousands of hours and miles at sea. We treat our clients with respect, we are responsive and not pushy. Our focus is to become your loyal advocate, always looking out for your best interests. The team at JMYS has extensive trawler and motor yacht product knowledge and our skills are available for coaching after the sale has concluded.

Co-Brokerage: Fellow yacht broker association members: This listing is available for co-brokerage and JMYS is a 50/50 house. Courtesy showings are available by appointment. Florida listings subject to appropriate broker licensing required by law.

This listing specification has been approved by the sellers for accuracy. The photos, images and descriptive content are copyrighted by JMYS and may not be copied or used without specific written permission. All inspections are by appointment only. Please contact listing broker, **Rob Piwowarczyk, CPYB** for additional information or to schedule a viewing appointment to inspect **High Spirit**.

***Listing Broker: Rob Piwowarczyk** is always available via Mobile +1 720.490.5662 (call or text). You can send a detailed Email to: Rob@JMYS.com.



Licensed and Bonded in California and Florida.

International Yacht Brokers Association | California Yacht Brokers Association

Selene 57 High Spirit

***Listing broker. Jeff Merrill, CPYB** (Certified Professional Yacht Broker) has extensive product knowledge of the trawler and motor yacht market and has been aboard the Selene 57 **High Spirit** on multiple occasions. Jeff has a twenty-five-year+ history of building and selling cruising boats providing his clients with experience and product knowledge that he is happy to share. Jeff is a familiar face to YouTube viewers, is a regular presenter at TrawlerFest and is one of the instructors for Boaters University online courses.



Licensed and Bonded in California, Florida and Washington.

Skype: jeff.merrill | You Tube: Jeff Merrill Yachts | Twitter: @merrillyachts | LinkedIn: jeff.merrill
Facebook: Jeff Merrill Yacht Sales | Instagram: jeffmerrilljmys | Yacht Brokers Association of America |
International Yacht Brokers Association (Florida) | Northwest Yacht Brokers Association |
California Yacht Brokers Association – President 2015 and 2016

