

# Florida Bay Coaster 65 *RED HEAD*



## JMYS

Jeff Merrill Yacht Sales, Inc. | [www.JMYS.com](http://www.JMYS.com)  
3010 Old Ranch Parkway, Suite 440 | Seal Beach, CA 90740

Florida address: Jeff Merrill Yacht Sales, Inc. | 3321 S.E. 14th Avenue | Ft. Lauderdale, FL 33316



## *RED HEAD*

**Asking Price: \$850,000.00**

**Location: Baltimore, MD**

# Florida Bay Coaster 65 *RED HEAD*

Watch her on YouTube:

Talk Through Tour:

<https://www.youtube.com/watch?v=mPIOcAUuu8c>

360 Trawler Spin:

<https://www.youtube.com/watch?v=0QtHIVnFD6A>

## **INTRODUCTION:**

At a distance it can be difficult to distinguish one trawler from another or, if you recognize the brand, it's often a guess to determine the correct size of the model.

Then you see one that is beautifully different. Captivating. A time suspending design.

The Jay Benford Florida Bay Coasters are part river boat, part waterfront home and completely solid underway. Built in the US and constructed out of steel, this is a stout and sturdy trawler that is surprisingly nimble underway.

**RED HEAD** is as famous as she is distinctive. There have been a handful of owners over time, most notably the music recording artist, Billy Joel. The current owners are very active captains who have owned multiple boats and been involved in the marine industry for decades.

Several years ago, **RED HEAD** was donated to the U. S. Merchant Marine Academy at Kings Point, NY. Knowing that the institute had to sit on her for some time before they could sell, the current owners kept their eye on her, letting the Academy know they were keenly interested. It was a noble pursuit that kept them excited after selling their last trawler, a DeFever 53. **RED HEAD** was quickly put under contract and had a positive survey.

It was also obvious that to meet their standards, the new owners were going to have to commit to a lot of restoration, improvements and upgrades. All told, over \$1.0 million dollars were lavished over a two-year period before serious cruising could commence and the spending has continued to address everything that pops up. For full time cruising, this is truly a remarkable waterfront home afloat. Amazingly, she is owned, maintained, and operated by a married couple with three dogs.

Being knowledgeable boat owners, they know that they will never be able to recapture the funds they have bestowed upon her, but that's OK. They have done what was needed and more and this will make it that much easier for the next owners to start off in a great position. Trying to quantify the value for the size and condition it is easy to see this is an extraordinary value.

**RED HEAD** has cruised from Maine to the Florida Keys, using the ICW and traveling offshore. Visually she may appear "top heavy" but that is an incorrect perception. She is graceful through the water and surprisingly fuel efficient with her twin Caterpillar 3208T's engines pushing 200,000 pounds. She enjoys cruising at 9.1 knots with an average burn of 4 gallons per hour from each engine.

The current owners have never had more fun with a boat, the experiences have been wonderful. The eastern seaboard is her stomping grounds, and the Bahamas are her favorite getaway. Now, after 5+ years with **RED HEAD**, and having previously cruised for decades on other boats, they are ready to take a

# Florida Bay Coaster 65 *RED HEAD*

break and are moving ashore. The timing is great for the next owner. **RED HEAD** is in exceptional condition, and this is the optimum time for them to sell and a buyer to step up.

Would you like to wander about, exploring, drifting, puttering, or to take off on a long passage? **RED HEAD** makes this all possible with spectacular views through windows and on deck making sure that being aboard never grows old.

|                           |   |
|---------------------------|---|
| <b>SPECIFICATIONS:</b>    |   |
| <b>YACHT NAME:</b>        | <b>RED HEAD</b>   |
| <b>BRAND AND MODEL:</b>   | Florida Bay Coaster 65  |
| <b>TYPE:</b>              | Steel coastal and offshore trawler (Bahamas, Caribbean)   |
| <b>LOCATION:</b>          | Baltimore, MD   |
| <b>MODEL YEAR:</b>        | 1989  |
| <b>HULL NUMBER:</b>       | 1   |
| <b>HULL COLOR:</b>        | PPG painted White and Haze Gray   |
| <b>DECK:</b>              | PPG painted White and Ivory   |
| <b>REGISTRY:</b>          | United States Coast Guard documented  |
| <b>DESIGNER:</b>          | Jay Benford   |
| <b>BUILDER:</b>           | Florida Bay Coaster Company - Palatka, FL USA   |
| <b>HULL MATERIAL:</b>     | Steel   |
| <b>DISPLACEMENT:</b>      | 200,000 lbs.   90.71 MT   |
| <b>SPEED:</b>             | Cruise 9.1 knots @ 8 GPH  |
| <b>RANGE:</b>             | 2,500 miles at cruise speed   |
| <b>LOA:</b>               | 65'   19.81 M   |
| <b>LWL:</b>               | 65'   19.81 M   |
| <b>BEAM:</b>              | 22'   6.71 M  |
| <b>DRAFT:</b>             | 5'   1.52 M (full load)   |
| <b>AIR DRAFT:</b>         | Approximately 35'   10.67 M (mast up)     25'   7.62 M (foremast down)     20'   6.1 M (electronics down)                                 |
| <b>PORT ENGINE:</b>       | Caterpillar 3208T @ 320 HP   (Hours~6,459 September, 2021)   ZF Microcommander electronics throttle controls   ZF transmission, ratio 3:1 |
| <b>STARBOARD ENGINE:</b>  | Caterpillar 3208T @ 320 HP   (Hours~6,164 September, 2021)   ZF Microcommander electronics throttle controls   ZF transmission, ratio 3:1 |
| <b>PROPELLER / SHAFT:</b> | PYI PSS dripless shaft seals   AquaDrives type HDL680   2-1/2" shafts   4-blade bronze propellers   |
| <b>THRUSTER:</b>          | Wesmar 60 HP hydraulic bow thruster   |
| <b>ELECTRICAL:</b>        | 60 Hertz – US style – 50-amp  |
| <b>SHORE POWER:</b>       | 50-amp for house and 50-amp air con (fore and aft connections)  |
| <b>GENERATOR 1 PORT:</b>  | Northern Lights 25kW generator Model M864 (~ 3,355 hours September, 2021)   |

# Florida Bay Coaster 65 *RED HEAD*

|                                    |   |
|------------------------------------|---|
| <b>GENERATOR 2 STARBOARD:</b>      | Northern Lights 25kW generator Model M864 (~ 3,227 hours September, 2021)   |
| <b>INVERTER/CHARGER:</b>           | (2) Magnum MS2812 true sine inverters (one for each AC panel)   Magnum controller displays   Blue Seas M2.1830DC state of charge house bank monitor   |
| <b>BATTERIES:</b>                  | (16) Trojan T-105 batteries for house bank including temperature monitors   (2) 8D engine start   Separate generator start  |
| <b>INTERIOR LIGHTING:</b>          | Low voltage LED lighting upgraded   |
| <b>CLIMATE CONTROL:</b>            | (3) MarineAir chillers and ten heat exchangers with circuit breakers and controllers   Teel 2.1 gallon pressure tank for MarineAir circulating system   Webasto auxiliary diesel heater for MarineAir system   Frigidaire room dehumidifier   |
| <b>MACHINERY EQUIPMENT:</b>        | Duplex Racor 900 fuel filters with gauges for CATs   Fuel manifold   Oil changing pump and manifold   Triple Racor 1000 filters with gauge for fuel polishing   Fuel pump for Racor 1000's with gauge   Racor 500 with gauge for each generator   (2) Isolation transformers                              |
| <b>WINDLASSES:</b>                 | (2) Maxwell 3000 electric windlasses each with foot switches  |
| <b>GROUND TACKLE:</b>              | (2) Mantus 179 lb, anchors   300' 1/2" chain for each anchor   (2) Bow line attachment/snubber 1" lines with connection to bow eye   (2) Mantus chain attachments   |
| <b>CARGO CRANE   DINGHY DAVIT:</b> | Foremast hydraulic boom lift 3,500 lb. capacity   Dinghy davit pivots, block and tackle with manual self-tailing winch   Electric hoist top deck 1,000 lb. capacity   |
| <b>ADDITIONAL HYDRAULICS:</b>      | Cargo well deck cover hinged with rams   Transom ramp hinged with rams  |
| <b>TENDER AND OUTBOARD:</b>        | AB 11ALX aluminum RIB with center console   Chartplotter, depth and 25W VHF   Yamaha F20 20 HP 4-stroke engine with electric tilt   |
| <b>KAYAKS:</b>                     | (2) Dagger 9' kayaks with covers and mounting straps  |
| <b>NAV/COM BRANDS:</b>             | Garmin   Icom   Furuno   Airmar   Sitex   |
| <b>WATER MAKER:</b>                | Sea Recovery Aqua Whisper 75 GPH water maker  |
| <b>ENTERTAINMENT:</b>              | Sony KDL-40HX800 large screen 40" TV with electric lift in saloon   Bose speaker system with five ceiling speaker pairs and sub woofer in saloon settee   Sony 7.1 channel A/V receiver and surround sound system   Sony Blu-ray disc player   Bose speakers   Digital Yacht amplified digital TV antenna |
| <b>STATEROOMS:</b>                 | Three: Owner top aft, Guest mid deck, Crew forward  |
| <b>HEADS:</b>                      | Three: Headhunter (electric freshwater)   Headhunter holding tank indicator   |
| <b>HOT WATER:</b>                  | 26 gallon American Water Heater plumbed to condensation tank  |
| <b>SHOWERS:</b>                    | Three: Stand up in owner head with door   Tub with shower in guest head with curtain   Crew cabin tile tub and shower   |

# Florida Bay Coaster 65 *RED HEAD*

|   |  |
|---|--|
| <b>LAUNDRY:</b>   | GE clothes washer   Frigidaire clothes dryer (both appliances full-size)   |
| <b>GALLEY:</b>  | AGA Companion four-burner LPG stove, with two 240VAC ovens   Broan 30" range hood   Miele full-sized dishwasher   Big Chill Retropolitan full-size refrigerator freezer   Sharp Carousel microwave oven   Breville toaster oven   Sub Zero (6) shelf wine cooler   Doulton drinking water tap   Slide out trash bin  |
| <b>INTERIOR WOOD:</b>   | Custom wood and cabinetry  |
| <b>INTERIOR COUNTERS:</b>   | Galley top is Zinc. Quartz and granite counters throughout   |
| <b>INTERIOR UPHOLSTERY:</b>   | Ultraleather   |
| <b>INTERIOR FLOORING:</b>   | Reclaimed oak hardwood throughout (much covered with carpet)   |
| <b>BILGE PUMPS:</b>   | Bilge pump and manual switch in chain locker   Bilge pump with auto/manual switch in forepeak   Spare bilge pumps and sensors   Multiple electric bilge pumps and sensors in lower level machinery chambers   AnyWater Alarm sensors in all bilge chambers   Emergency bilge pump system with 240V pump and manifold |
| <b>TANKAGE:</b> (approx.)   |  |
| <b>FUEL:</b>  | 2,500 gallons   9,464 Liters (Four integral steel tanks)   |
| <b>HOLDING BLACK:</b>   | 550 gallons   2,082 liters (One 500 gal. integral steel tank for owner and guest, and one 50 gal. vinyl for crew)  |
| <b>FRESH WATER:</b>   | 1,400 gallons   5,300 Liters (2 aluminum tanks)  |
| <b>PROPANE:</b>   | (3) 98 lb. tanks in isolated locker  |
| <b>SAFETY:</b>  | Fireboy engine room fire suppression system in each engine room   USCG safety package   Kannad EPIRB on roof of stack   Viking 6-person liferaft   CO detectors   (10) handheld fire extinguishers   Fireboy XINTEX propane sensors   High water alarm for each compartment   AnyWater alarm with (12) hull sensors  |
| <b>PHOTO DATE:</b>  | Most photos taken August 2021  |
| <b>Note: All information is believed accurate but should be verified.</b> |  |

## MAIN DECK



# Florida Bay Coaster 65 *RED HEAD*

## GALLEY:

There are port and starboard side decks that wend their way aft to the easiest interior access. Most commonly you will dock port side and arrive at the gathering area aft which includes the galley and saloon. This great room has the galley forward, with the saloon aft. There is a counter island with bar stools that divide the space by name, but it is one large, inviting area. The island has a sensational zinc counter on top with a lower quartz counter. There is a single basin stainless sink and multiple drawers. Also in the island is the dishwasher and a slide out trash bin. The aft part of the zinc top is addressed with three bar stools that swivel and provide a wonderful place to view and converse. There is a stainless footrest running along the lower edge of the island.

The primary galley appliances are conveniently located forward with the AGA Companion four burner propane grill, some counter surface for appliances and a huge, full-size Big Chill refrigerator top with freezer bottom. Across the hall in the same area is a microwave oven.

- AGA Companion (4) burner propane stove with (2) electric ovens
- Broan 30" range hood with fan and light
- Fireboy X1NTEX propane sensor and controller
- Miele full-sized dishwasher
- Big Chill Metropolitan full-size refrigerator with lower freezer
- Sub Zero six shelf wine cooler
- Breville toaster oven
- Sharp Carousel microwave oven
- Stainless steel sink
- Doulton drinking water at sink
- Built-in hand soap dispenser
- Full zinc bar counter top
- (3) Hi-low bar stools on saloon side of island counter
- Stainless steel bar rail around outside of bar with 7 Gryphons
- Quartz galley counters
- Inside custom sun and bug screens for all doors
- Fire blanket for emergencies (under sink)
- Fire extinguisher (under sink)
- Slide out trash bin
- Storage for pots and pans
- Overhead lockers
- Most galley appliances

## SALOON:

Working aft from the galley is the enormous saloon. The entire sole is covered with reclaimed oak from an old barn in Maine and then carpeted over top. There are two Dutch doors from the side decks forward and also a double opening door aft to the Poop deck. There are windows all around that have tasteful coverings and give you an incredible view of your surroundings. This is the area where you will dine and relax. On the port side is a large L-shaped couch with an equally large dining table. There are two comfortable chairs that can be repositioned as you please. On the starboard side is white painted

# Florida Bay Coaster 65 *RED HEAD*

cabinetry that conceals the 40" flat screen television on a lift. The sense of space and being in your surroundings is very appealing.

- Port side L-shaped built-in seating
- New ultra-leather settee cushions
- (2) Large leather swivel chairs
- Custom hi-low table with extension to fold out
- Large Ratan trunk
- Several built-in painted cabinet areas with lockers and drawers
- Forward cabinetry with additional drawers and lockers with clear glass doors
- (2) Driftwood 3-way lamps with LED lights
- (4) Framed paintings
- (2) AC/heat exchangers (in cabinets on port and starboard side)
- Inside custom sun and bug screens for all doors
- Windows on both sides and aft with drapes
- Oak hard wood flooring (carpeted)

Entertainment:

- Sony KDL-40HX800 40" large screen TV with integrated up/down controls
- Bose speaker system with 5 ceiling speaker pairs and sub woofer in settee
- Sony 7.1 channel A/V receiver and surround sound system
- Sony Blu-ray disc player Built-in infra-red remote sensors

## **POOP DECK**

A convenient landing area. This space is a covered outside deck area that has hawseholes and cleats for tying up as well as a shore power connection. There is a boarding door on the port side. The center bulwark is also a hinged ramp that is hydraulically operated to lower and serve as a dock platform.

- Hydraulic ramp
- Boarding gate to port
- Hawseholes and cleats
- Shore power connections

## **GUEST STATEROOM**

Moving forward from the galley/saloon you have a door that leads down to the machinery space and a short set of steps that leads up to the mid deck landing. The landing has an opening window and built-in cabinetry for storage with a convenient counter ledge. From the landing you can go forward into the guest stateroom, inboard to the guest head, or up the stairs to the pilothouse / owner cabin deck level.

The guest stateroom has a queen-sized bed positioned athwartship for easy entry from three sides. There are windows forward and along the sides. The forward starboard corner is set up with counters extending in both directions to create a desk area with a chair and printer. There are lockers and drawers. The sole is carpeted.

- Queen size bed

# Florida Bay Coaster 65 *RED HEAD*

- Drawers and lockers
- Multiple opening windows with drapes
- Office/desk area to starboard
- Printer
- Rattan chair

## **GUEST HEAD**

This head is at the landing area making it convenient for guests in the gathering deck area and as the dedicated head for the guest stateroom. The floor is tiled, there is a freshwater toilet, sink and spacious tub/shower.

- Sink
- Shower and tub
- Mirrored medicine cabinet
- Headhunter toilet
- Opening window

## **FOREDECK:**

The foredeck is ship-like, towering over the water with high, protective railing. Forward are two Mantus anchors, each directed to a separate electric windlass via chain rode. The forward anchor well has a dam to contain chain wash and there is a Freeman hatch to give access to the chain locker. The prominent foremast has ratlines and a Crow's nest. It can be lowered. There is a hydraulic pump that powers the controls for the cargo boom which can lift gear from a dock or wharf and deposit it into the cargo hold. Below the foredeck is the crew quarters.

- Mast and boom with large hydraulic motors for lifting larger loads (dinghy, etc)
- Twin cable ladders leading to crow's nest
- (2) Maxwell 3000 windlasses each with foot switches
- Chain locker with 300' 1/2" chain for each anchor
- (2) Mantus 179lb anchors
- (2) bow line attachment/snubber 1" lines with connection to bow eye
- (2) Mantus chain attachments
- (2) chain lock plates with locking pins for each anchor channel
- Built-in wash down pump (ceiling of forepeak) with attachment on focsle floor
- Washdown hose and nozzle with quick connect
- Washdown power wand with quick connect
- Large locking port hole deck hatch to access chain locker
- Bilge pump and manual switch to remove occasional water from chain locker
- Manual bilge pump to remove occasional water from chain locker
- Extra very large storm lines around chain barrels in chain locker
- Bow flag pole with red triangular flag
- Freeman hatch above anchor locker
- Freeing ports



# Florida Bay Coaster 65 *RED HEAD*

## FORECASTLE

This area is set up as crew quarters. There is a large door access from the cargo deck to enter. There are two single berths, each outboard along the hull side. Forward is a bank of drawers and overhead storage. By the entrance door there is a large hanging locker. There is immediate access to the machinery deck via a set of stairs and there is a folding floor cover over the steps. There are opening portlights outboard. Aft, to port, is the enclosed head with sink, toilet and tub shower.

- Two bunk beds
- Opening port lights
- Drawers
- Lockers
- Teak and spruce sole
- Large hanging locker
- Folding floor landing over steps to machinery deck
- Headhunter freshwater toilet
- Sink
- Shower and tub

## UPPER DECK PILOTHOUSE AND OWNER:

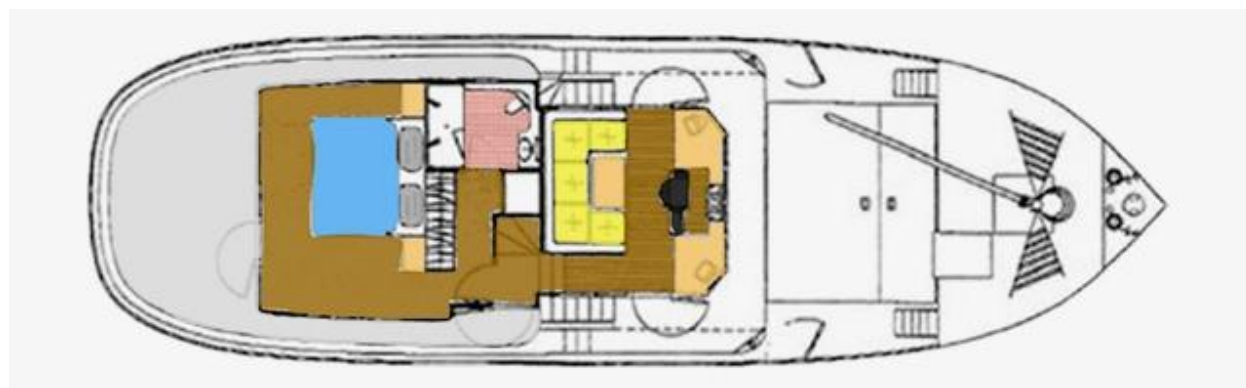

## PILOTHOUSE:

The view for running *RED HEAD* is spectacular, this is a raised pilothouse platform that is aft for a more comfortable ride and excellent visibility. You can get to the pilothouse from the inside up the central stairway that connects the lower deck to the mid deck and then up to this level. The pilothouse has two doors to the outside deck which is a very wide Portuguese bridge forward and side decks to head aft. The navigation and communications are situated for easy operations. There is a Stidd helm chair on a side-to-side adjustable track. Outboard on both sides of the dash are wide surfaces for charts and gear. The electrical breaker panel for the navigation equipment is to port and there are drawers for storage. Behind the helm chair is a large C-shaped settee with a table. The table can be lowered to convert this settee into a berth.

- Stidd helm chair on sliding track
- Stainless-steel destroyer wheel
- Garmin 8617 chart plotter
- Garmin GPS19X

# Florida Bay Coaster 65 *RED HEAD*

- Garmin GMR1224 12K open away radar
- Garmin Reactor 40 autopilot (pump and ECU in lazarette)
- Garmin GHC 20 autopilot controller display
- Kobelt 7175 M rudder indicator
- Garmin handheld autopilot remote
- Furuno DRS3W 4K radar (Radome on roof, displays on any iPad)
- Garmin Card Reader unit 3887268450 (RED HEAD Inventory)
- Maretron WSO100 ultrasonic wind sensor
- Actisense NGT-1 NMEA 2000 to USB interface (for Raspberry Pi)
- (2) Airmar DT200 depth transducers
- Airmar DST200 depth and speed transducers (speed is disabled)
- AIS - West Marine AIS 1000 with dedicated antenna
- Sitex Hemisphere V104N Vector satellite compass with roll, pitch, and yaw sensors
- Digital Yacht NavLink2 NMEA 2000 to WiFi interface
- Icom IC-M605 VHF with remote mic and dedicated antenna
- Icom IC-M330 VHF with dedicated antenna
- RAM mounts for 2 large iPads (lower) and 1 small iPad (upper) each with power cords
- Temperature gauges for each CAT
- Oil pressure gauges for each CAT
- Tachometers for each CAT
- Hydraulic clutch and alarm switches for each engine
- Hour timer dual ringing alarms for CATs
- Hydraulic clutch and alarm switches for each engine
- ZF Microcommander electronics throttle controls
- (2) ZF Microcommander tethered remotes
- ZF Microcommander 25' extension tether to reach bow
- Bow thruster control on helm desk
- Emergency bow thruster controller under helm on port side (wired into relay box)
- Google Mesh WiFi system 4 connected routers - pilothouse, owner's stateroom, mezzanine, utility room
- Groove outside high-gain modem on roof of stack
- Kahlenberg whistle and controller, Kahlenberg horn (very loud!) with button next to throttles
- DC panel for electronics, lighting, and other DC power in pilothouse
- High power tug spotlight with pilothouse tilt/swivel control arm
- Red/white room overhead light
- Outdoor flood light switch
- Outdoor mast spreader light switch (on DC panel)
- Emergency canned air horn
- Raspberry Pi - Signal-K interface,
- Weboost Drive 4G-X cellular amplifier and inside antenna

# Florida Bay Coaster 65 *RED HEAD*

- High water alarm system including sensors for: Forepeak Cargo area, Port engine room, Starboard engine room, Pump room, Lazarette
- AnyWater alarm controller network interface
- Jason PermaFocus 2000 7x50 binoculars
- Weems & Plath clock
- Weems & Plath barometer
- Weems & Plath clinometer
- Weems & Plath temperature and humidity
- (2) AC/heat exchangers (1 is for guest stateroom, mounted under helm & under settee)
- Electronics panel with breakers
- Red overhead lights
- Engine controls
- Windshield wipers with washers
- Drawers and lockers
- Side deck door to port and starboard with canvas bug screens
- Note: iPads do not convey, they contain proprietary information and will be removed prior to closing

## **OWNER STATEROOM**

This is truly the best room aboard. Located up high and aft above the saloon, this room has a king-sized bed with wide walking floor space surrounding. There are windows outboard and aft. The bed has built in stands on each side. There are lockers and drawers. The door aft opens to an outside covered patio deck. Moving forward from the stateroom you can go forward to the upper landing – ahead to the pilothouse or outside to the starboard deck. Turning inward you pass through a wonderful closet area with locker and drawers for closing and that connects to the private owner's head.

- King-sized bed
- Carpeted floors
- Large hanging lockers
- Multiple drawers
- Bed stands
- Door aft to outside deck area

## **OWNER HEAD:**

Behind the stateroom door, there is a walk-through area with clothing lockers and drawers that leads to the ensuite head and shower. Tiled floors, a custom floating sink, Headhunter freshwater toilet and an opening window outboard. The shower is huge, a two-person sized shower.

- Double sized shower
- Custom floating sink
- Headhunter freshwater toilet
- Opening windows with drapes
- Lockers and drawers

# Florida Bay Coaster 65 *RED HEAD*

## **OWNER OUTSIDE DECK**

The outside deck is directly accessed through the owner stateroom door. This is a covered deck area with high railing. An assortment of comfortable outdoor seats and tables compliment this area as a coveted location for relaxing.

- Outdoor seats with comfortable cushions
- Outdoor tables

## **MACHINERY DECK**

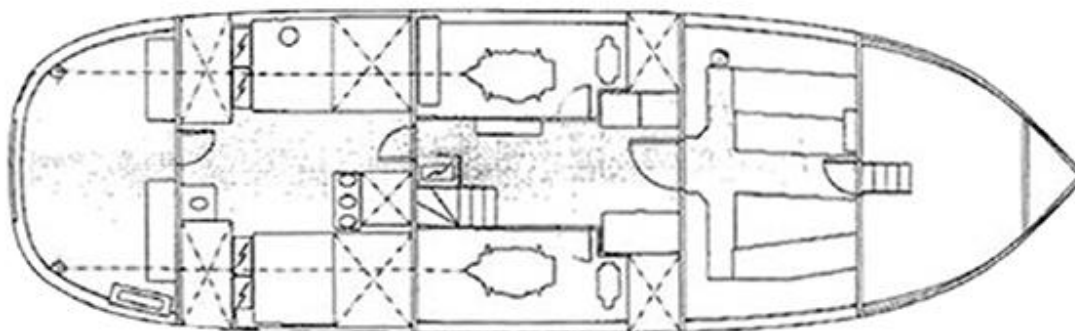

## **MACHINERY CHAMBERS**

Through a door forward of the galley you descend a short flight of stairs to arrive in the center or main chamber of the machinery spaces. This central location provides immediate access to the two engine rooms, which are isolated outboard behind closed doors. There are four collision bulkheads in this lower area.

The layout of equipment was focused on easy access to make inspections and service convenient. In the furthest chamber aft contains the autopilot and steering assembly. There is also a hydraulic pack and ram to operate the Poop deck lowering ramp. Throughout the machinery area there are water sensors that alert the AnyWater alarm system. Serious effort by the current owners has been lavished to make this deck level clean, fresh and dry.

The second chamber forward (pump room or tank deck) includes freshwater tanks, water maker and chilled water air-conditioning as well as batteries and the water heater tank. Beneath the stairs are two inverter chargers and the Racor filters for fuel filtering. In the main chamber, a fuel manifold is installed inside a work surface that includes a vice. Forward to port in the main chamber are the laundry appliances – full-sized clothes washer and dryer. There are electrical breakers and display panels. Duplex Racor fuel filters are located inboard and outside of each engine room. There is a Northern Lights 25 kW generator sharing the space with each Caterpillar main engine.

An impressive tool chest with drawers completes this chamber. Going forward through the walk through collision bulkhead brings you to the cargo bay. Above, two huge doors open hydraulically to allow for the cargo boom above to move supplies. The cargo deck has previously housed a car and two motorcycles. There is a sink to port and this entire chamber is methodically organized with bins full of spares that are neatly labeled and ready for most projects that may come up. At the front of the cargo bay is a set of steps that leads up to the Forecastle crew quarters.

# Florida Bay Coaster 65 *RED HEAD*

## Port Engine Room:

- Entry door with viewing window
- Caterpillar 3208 main engine 320 HP
- Caterpillar starting battery bank (2) 8-D's
- Hydraulic pump and clutch on Caterpillar with full set of spare belts
- ZF Microcommander throttle controller
- Twin Racor 900 fuel filters with gauge
- Walker Airsep air filter
- Large Groco strainer for engine
- PYI PSS dripless shaft seal
- AquaDrive type HDL680
- Northern Lights 25kW M864W3 generator
- Racor 500 with gauge for generator
- Starter battery for generator
- Small Groco strainer for generator
- Kahlenberg compressor unit
- Large Kahlenberg pneumatic tank with gauge
- Room thermometer
- Engine room blower
- Fireboy automatic engine fire extinguisher
- Opening port light

## Starboard Engine Room:

- Entry door with viewing window
- Caterpillar 3208 main engine 320 HP
- Caterpillar starting battery bank (2) 8-D's
- Hydraulic pump and clutch on CAT with full set of spare belts
- ZF Microcommander throttle controller
- Twin Racor 900 fuel filters with gauge
- Walker Airsep air filter
- Large Groco strainer for engine
- PYI PSS dripless shaft seal
- AquaDrive type HDL680
- Northern Lights 25kW M864W3 generator
- Racor 500 with gauge for generator
- Starter battery for generator
- Small Groco strainer for generator
- Room thermometer
- Engine room blower
- Fireboy automatic engine fire extinguisher
- Opening portlight

# Florida Bay Coaster 65 *RED HEAD*

## Machinery areas

- AnyWater Alarm control panel
- Clothes washing machine - GE WCVH4800K2WW
- Clothes Dryer - Frigidaire FEQ332ES0
- Water filter for washing machine
- Twin bilge pumps with auto/manual switch
- Cepac electrocatalytic meter AC distribution panel
- Twin isolation transformers
- Vise
- Handheld temperature meter
- Ear protection (3 sets)
- Fuel manifold
- Oil changing pump and manifold
- Triple Racor 1000 filters for fuel polishing
- Fuel pump for Racor 1000's with gauge
- Port AC electrical panel
- Starboard AC electrical panel
- DC electrical panel
- Large DC item panel
- Maxwell windlass circuit breakers
- (2) CO detector monitor
- Start battery bank transfer switches (2+ combiner switch)
- White board
- AC/heat exchanger (above washer/dryer)
- Blue Seas M2 1830DC state of charge house bank monitor
- Underwater light controls (forward and aft)
- Headhunter holding tank indicator WTS1500 – 2
- Magnum controller/display (2) for each inverter
- MarineAir DDC chilled water master control
- Port engine gauge set, emergency stop, and enable panel
- Starboard engine gauge set, emergency stop, and enable panel
- Port generator gauge set, start, stop, and battery switches/panel
- Starboard generator gauge set, start, stop, and battery switches/panel
- (2) Magnum MS2812 true sine inverters (one for each AC panel)
- Magnum AC breakers
- Pneumatic air access fitting (next to port panel)
- Small pneumatic hose and pressure controller with gauge
- Medium size inverter above Magnum inverters (unused)
- Overboard discharge pump and holding tank valve
- Holding tank indicator pump
- Full Craftsman mechanics set of US and metric sockets

# Florida Bay Coaster 65 *RED HEAD*

## Cargo chamber:

- Two large opening doors with hydraulic rams
- Hydraulic reservoir
- Fresh water sink
- Incredible assortment of spare parts bins

## DECKS

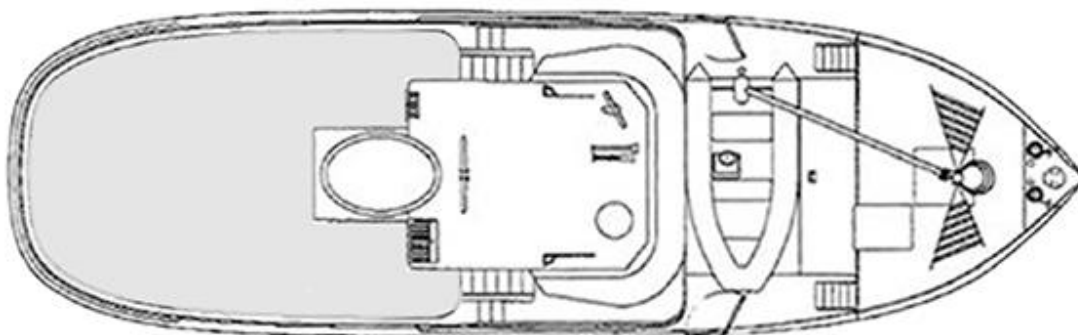

## SUNDECK:

The upper most deck is a spacious area with an incredible amount of outdoor space. There are high railings all around. An electric hoist is installed on the port side for lifting kayaks or the portable dock. There is a steering helm on the port side built into the pilothouse roof. The stack is stylish and it is easy to get atop the roof to check out the antennas and other gear like the Kahlenberg horn trumpets and search light. The stairs are wide and have a comfortable angle. Room for all kinds of lounge chairs, exercise equipment, even a large outdoor awning would work well up here.

- Tall railing
- Electric hoist
- Floating dock for waterline service
- Two kayaks
- Upper helm station
- Light tower

## CARGO DECK:

The Cargo deck has two large, hinged doors that are hydraulically activated to provide access to the cargo hold below. This is a commercial ship attribute that is extremely uncommon on a recreational cruising boat. The doors also have chocks to support and store the inflatable tender. This entire area is well protected with side deck railing. Forward there is storage up against the forecabin for lines and fenders. The hydraulic cargo boom is attached to the foremast for heavy lifting. The pilothouse and Portuguese bridge align with the aft area. There is a clever pivoting davit with a block and tackle arrangement for handling dinghy launching and retrieval. The outboard decks each have boarding doors and a clear walkway to doors that open into the interior.

- AB 11ALX aluminum RIB with center console
- Yamaha F20 20hp 4 stroke engine with electric tilt

# Florida Bay Coaster 65 *RED HEAD*

- Built-in 6 gallon gas tank
- Garmin 942 chart plotter with built-in depth transducer
- Icom CommandMic HM-195B 25 watt VHF with tilt-mount antenna
- Dinghy davit with manual winch for launching/retrieving dinghy (instead of using crane)
- Dinghy davit extra mount on opposite side for launching on port side
- Dual well deck floor segments with 4 electric/hydraulic rams for raising well deck fully
- Removable dinghy mounting chocks

## **FOREDECK:**

You ascend to the raised foredeck via built in ladder steps on both sides. This is a spectacular platform for handling anchoring chores. There are two anchor rollers with large Mantus anchors and two Maxwell electric windlasses. The anchor well has a dam to retain muddy water and direct it overboard. There is a Freeman hatch above the chain locker. The impressive foremast is supported with stays and has a Crow's nest that is accessed via side ladders. The mast also has a hydraulically controlled lifting boom for large loads from shore to the cargo hold. The foremast can be lowered to clear under low bridges.

- Mast and boom with large hydraulic motors for lifting larger loads (dinghy, etc)
- Twin cable ladders leading to crow's nest
- (2) Maxwell 3000 windlasses each with foot switches
- Chain locker with 300' 1/2" chain for each anchor
- (2) Mantus 179 lb. anchors
- (2) Bow line attachment/snubber 1" lines with connection to bow eye
- (2) Mantus chain attachments
- (2) Chain lock plates with locking pins for each anchor channel
- Built-in wash down pump (ceiling of forepeak) with attachment on forecastle floor
- Washdown hose and nozzle with quick connect
- Washdown power wand with quick connect
- Large locking port hole deck hatch to access chain locker
- Bilge pump and manual switch to remove occasional water from chain locker
- Manual bilge pump to remove occasional water from chain locker
- Extra very large storm lines around chain barrels in chain locker
- Bow flagpole with red triangular flag

## **SAFETY EQUIPMENT:**

- All US Coast Guard required equipment
- (4) Collision bulkheads
- Fireboy automatic engine fire extinguisher in each engine room
- (2) Adult life vests
- (1) Inflatable life vest
- (1) Throwing cushion
- (20) Adult PFD's (approx.)
- First aid kit
- Sirius Signal SOS C-1001 electronic flare



# Florida Bay Coaster 65 *RED HEAD*

- CO detectors throughout
- USCG Navigation Rules book
- Flare gun
- Fire blanket for emergencies (under galley sink)
- Fire extinguishers: multiple locations
- Fireboy X1NTEX propane sensor and controller
- (4) Space/emergency rescue blankets
- Package of light sticks
- (3) Day distress signal flags (1 in sealed case)
- Inflatable arming kit (partial)
- (2) Quarantine yellow flags
- US Nautical Chart 1 book
- Chapman's Emergencies at Sea book
- Departure checklists (laminated)
- Explorer chart book for Bahamas
- Cobra handheld VHF battery back plate and NMEA interface
- Spare Garmin 17X GPS Handheld

## **LISTING BROKERS COMMENTS:**

**RED HEAD** is massive. She is a huge house on the water as comfortable offshore in the breeze as she is anchored in a shallow cove. Her condition is amazing. You will not believe you are on a boat that was launched many years ago, she is lovingly cared for and kept fresh through active use.

A detailed 22-page inventory list is available by request which goes into greater detail to identify the incredible amount of gear included.

She has been rated for commercial charters and safety is at the forefront. There are four collision bulkheads in the lower deck. An incredible series of bilge pumps and the AnyWater sensor keeps the crew alert to the slightest water intrusion.

The interior layout is practical and the heft of the boat keeps her stable at anchor and underway. The great room with saloon and galley is a wonderful gathering place for preparing meals, dining or relaxing to television and music.

The interior stairs lead up to the mid deck with guest stateroom (office inside) and a separate head and shower. Going up the stairs to the next level you reach the pilothouse forward and owner cabin aft. The owner cabin is amazing and the pilothouse has the necessary equipment for safe navigating.

The decks surrounding the house give you multiple outside walkways and the sundeck up top is a huge area. The profile with the cargo deck gives her a very salty and serious look. The forecastle with foredeck atop and crew quarters below is an ideal use of space. The cargo deck opens up with two large doors to reveal the machinery deck.

Each engine and generator is secure inside its' own room. The ability to transit the machinery deck chambers from stern to bow also gives you easy access for service and maintenance. The array of tools and spare parts in inventory is beyond comparison.

# Florida Bay Coaster 65 *RED HEAD*

The fit and finish inside and out is a testament to the care the current owners have given *RED HEAD*. For a home on the water, that will travel with surprising agility, there really is nothing like this available. She deserves your consideration and we invite you to get in touch with listing broker, Jeff Merrill to schedule your personal viewing.

For additional information please visit *RED HEAD's* website: [www.FloridaBayCoaster65.com](http://www.FloridaBayCoaster65.com)

**Exclusions:** Potential purchasers should assume that items on the vessel at the time of viewing, but not specifically listed on this sheet, are not included with the sale of the yacht. These specifications are believed to be true and correct but cannot be guaranteed. Items excluded include, but are not limited to paintings, tools, handheld nav gear and binoculars. Owner's personal effects and clothing will be removed prior to closing.

**Disclaimer:** Jeff Merrill Yacht Sales, Inc. presents the details of this vessel in good faith but cannot guarantee or warrant the accuracy of this information nor guarantee or warrant the condition of the vessel. Buyers should instruct their agents and their surveyors to investigate all details the buyers desire validated. This vessel is offered subject to prior sale, price change, or withdrawal without notice.

**Brokerage:** JMYS is a US based (licensed and bonded yacht brokerage in California, Florida and Washington) with an international emphasis specializing in ocean capable trawlers and recreational tugs. Our brokers are experienced boaters, most are trawler owner/operators with thousands of hours and miles at sea. We treat our clients with respect, we are responsive and not pushy. Our focus is to become your loyal advocate, always looking out for your best interests. The team at JMYS has extensive trawler and motor yacht product knowledge and our skills are available for coaching after the sale has concluded.

**Co-Brokerage:** Fellow yacht broker association members: *RED HEAD* is available for Co-Brokerage.

# Florida Bay Coaster 65 *RED HEAD*

**\*Listing broker. Jeff Merrill, CPYB** (Certified Professional Yacht Broker) has extensive product knowledge of the trawler market plus direct experience with steel trawlers. Jeff was her listing broker several years ago and has kept in regular contact with her current owners. He has been aboard and underway several times. Jeff is a familiar face to YouTube viewers and a regular presenter at TrawlerFest. He writes about trawlers for *Ocean Navigator* and *PassageMaker* magazines and is one of the online instructors for Boaters University.

This listing specification has been approved by the sellers for accuracy. The photos, images and descriptive content are copyrighted by JMYS and may not be copied or used without specific written permission. All inspections are by appointment only. Please contact listing broker, **Jeff Merrill, CPYB** by phone- call or text his mobile +1 (949) 355-4950 for email for additional information or to schedule your personal showing. You can send a detailed email to: [Jeff@JMYS.com](mailto:Jeff@JMYS.com)



**Licensed and Bonded in California, Florida and Washington.**

Skype: jeff.merrill | You Tube: Jeff Merrill Yachts | Twitter: @merrillyachts | WhatsApp  
LinkedIn: jeff.merrill | Facebook: Jeff Merrill Yacht Sales | Instagram: jeffmerrilljmys

Yacht Brokers Association of America  
Yacht Brokers Association (Florida)  
Brokers Association  
Association – President 2015 and 2016

International  
| Northwest Yacht  
California Yacht Brokers

