

Seahorse 52 Paradox II



JMYS

Jeff Merrill Yacht Sales, Inc. | www.JMYS.com
3010 Old Ranch Parkway, Suite 440 | Seal Beach, CA 90740

Florida address: Jeff Merrill Yacht Sales, Inc. | 3321 S.E. 14th Avenue | Ft. Lauderdale, FL 33316



Paradox II

Price: \$508,500.00

Location: Marco Island, FL

Jeff Merrill Yacht Sales, Inc. © 2022 All Rights Reserved www.JMYS.com

Seahorse 52 Paradox II

INTRODUCTION:

Paradox II is an exceptional example of one of the best kept secrets of the trawler world. Most people have heard of Diesel Ducks, designed by George Buehler and built by Seahorse Marine in mainland China. What many do not know is that Seahorse Marine also builds a rugged, full displacement long range cruiser, the Seahorse 52. The hull form is all sailboat (the Mandarin 52 to be precise) and Bill Kimley worked with Blaine Seeley to develop a new layout and deck to upgrade this proven hull form and convert it into an ocean ready trawler. About (30) Seahorse 52's have been built and they are now cruising all over the planet. Ocean capable? Yes! One completed a circumnavigation.

Paradox II did her initial cruising on the US west coast and was purchased by sailors ready to convert to power. She is a twin-engine edition that traveled through the Panama Canal, then cruised across the Caribbean to Florida. She was sold in Jacksonville, FL to another sailing couple. They took a great boat and made it even better. Air conditioning, watermaker, plus a new dinghy and crane were fitted. They cruised the eastern seaboard for two years and after enjoying their turn, sold her and returned to sail.

Enter the current owners who were thinking about an older Hatteras or DeFever until they happened upon the Seahorse 52 and were immediately smitten. They have worked through the typical survey items and have cruised both coasts of Florida. In addition to a dedicated desire to keep her clean as an operating room (they are both physicians) their major capital improvement is the installation of Naiad active fin stabilizers. The engine room is almost stand up in the keel alley. They love everything about **Paradox II**, except her speed. They want to move up to a faster boat, which is why she is for sale.

Paradox II is an ideal couple's cruiser, featuring an owner cabin aft (amidships) with guest cabin forward. Both cabins have built in desks, a rarity in a power boat under 100'. There is a hallway head for guests and the owner stateroom has an ensuite head and shower (with a tub!). The raised pilothouse has a helm chair forward with a settee behind. The entry level is a traditional saloon merging into a galley. The engine room is beneath the saloon and divided into two chambers – generator aft and engines forward. On deck, you can walk all around secured by tall stainless railing. There is a swim platform for arriving by dinghy that leads into the cockpit. The foredeck is uncluttered, just deck hatches and the windlass station forward. Working past the pilothouse to port you walk up a few steps to the boat deck which has an inflatable console dinghy and crane. Up a couple more steps takes you to the flybridge – the best place to operate when the weather cooperates and a marvelous place to relax and enjoy the view when you are stationary.

This Seahorse 52 is truly in ready to go condition. These are the type of owners you would like to buy a boat from.

Paradox II's profile is pleasing with her sailboat – through the water friendly - hull topped with a raised pilothouse trawler deck. Below her flybridge, she has a raised pilothouse with reverse raked windshield. To the unfamiliar it is hard to tell from a distance if you are looking at a Selene, Kadey-Krogen or a Nordhavn, the Seahorse 52 is in that same ocean crossing breed.

Seahorse 52 Paradox II

The craftsmanship and quality lavished by the Seahorse ship yard creates a great first impression that lasts. The teak joinery is hand crafted and the stainless work is hand polished. The hull is painted and on deck there is canvas, dinghy and the usual trawler accoutrements. The on-deck layout is easy to move about and the interior space logically connects from room to room. This is a versatile trawler you really need to step aboard to appreciate.

For 52-feet, you will have a difficult time finding a better overall trawler value.

SPECIFICATIONS:	
YACHT NAME:	<i>PARADOX II</i>
BRAND AND MODEL:	Seahorse 52
TYPE:	Long range raised pilothouse trawler yacht with flybridge
LOCATION:	Marco Island, FL
MODEL YEAR:	2007
HULL NUMBER:	21
HULL COLOR:	Awlgrip 2000 Kingston Gray
DECK:	White deck with gray nonskid (gelcoat)
REGISTRY:	United States Coast Guard documented
DESIGNER:	Blaine Seeley
BUILDER:	Seahorse Marine - Zhuhai, China
HULL MATERIAL:	Solid fiberglass
DISPLACEMENT:	67,000 Pounds 30.4 MT
SPEED:	Cruise 7.2 knots @ 1,500 RPM. Top 9.7 knots WOT
RANGE:	1,600 nautical miles at 7 knots
SPEED:	Cruise 7-9 knots, Top 11 knots
LOA:	52'0" 15.85 M
LWL:	46'2" 14.07 M
BEAM:	15'0" 4.57 M
DRAFT:	5'0" 1.52 M
AIR DRAFT:	28'0" 8.54 M. Note: Mast has hinge on base, air draft profile can be lowered to approximately 18' 5.49 M - A sistership has completed Great Loop.
PORT ENGINE:	John Deere 4045TFM75 - 4.5 Liter, Turbocharged - 135 HP (Hours~ 4,219 April 2022) ZF Clear command throttle and gear controls with Murphy Power-View monitors. (Engine refurbished in 2017).
TRANSMISSION:	ZF IRM-220-A, 3.0:1 transmission Seal Master thrust bearings with universal joints

Seahorse 52 Paradox II

STARBOARD ENGINE:	John Deere 4045TFM75 - 4.5 Liter, Turbocharged - 135 HP (Hours~ 4,442 April 2022) ZF Clear command throttle and gear controls with Murphy Power-View monitors.
TRANSMISSION:	ZF IRM-220-A, 3.0:1 transmission (rebuilt in 2021) Seal Master thrust bearings with universal joints
PROPELLERS / SHAFTS:	1.75" Stainless steel shafts PSS shaft seals 4 blade bronze propellers 28" x 21" Spurs line cutters
MAIN EXHAUST:	Wet exhaust
THRUSTER:	Side Power SP 95 24VDC bow thruster with controls in pilothouse and flybridge
STABILIZATION:	Naiad 252 Mulitsea II hydraulic active fin stabilizers (2017) Sea Gyro SG5K stabilizer with dedicated Magnum 230V pure sine wave inverter - note: Sea Gyro is not in service at this time.
STEERING:	Teleflex Capilano two stations Copper pipes PSS rudder log seal Emergency tiller
ELECTRICAL:	60 Hertz – US style
SHORE POWER:	50-amp and 30-amp
GENERATOR:	9kW Northern Lights M773LW2 with sound shield and dedicated 12V Lifeline battery Racor-500 MA filter/separator (~ 2,756 hours April 2022)
INVERTER/CHARGER:	Heart Interface Freedom 2500W Inverter charger Xantrex Pathfinder automatic charging selector
INVERTER/CHARGER 2 (Sea Gyro):	Dedicated Magnum 230V pure sine wave inverter for Sea Gyro Electric motors and drive belts refreshed 2017
HOUSE BATTERIES:	(12) Lifeline 6V 220-amp hour Lifeline batteries in house bank (2016). Total 660-amp hours at 24V.
START BATTERIES:	(4) Lifeline 12V Lifeline start batteries, two per engine (2016) One spare in in lazarette.
INTERIOR LIGHTING:	Halogen lighting
CLIMATE CONTROL:	Dometic Marine HVAC air conditioning: 52,000 BTU (4) compressors (2017) New compressor in Owner cabin (2020) Webasto hydronic diesel furnace with two zones and two thermostats which work independently (pilot house and owner stateroom)

Seahorse 52 Paradox II

MACHINERY EQUIPMENT:	Gulf Coast oil filters Seachest for raw water distribution Racor75-500 FGX duplex for mains Walbro 24 V fuel transfer pump with Griffin G-1000 polishing filter Floodlight in pilothouse SeaVac central vacuum with attachments Acme electric 15 kVA isolation transformer Fail-Safe galvanic isolator
WINDLASS:	Muir HR 2500 Cheetah 24VDC electric windlass, with deck and flybridge controls plus digital pilot house controller.
GROUND TACKLE:	80 LB. Manson Supreme primary 300' of 3/8" chain Danforth as secondary 100' 3/8" chain and 200' of braided nylon
CRANE:	Steelhead ES-1000 - 1,000 LB. lift (2018)
TENDER AND OUTBOARD:	11' Inmar 330R-AL console (2017, FL registration) Tohatsu 20 HP outboard
NAV/COM BRANDS:	Garmin Simrad Icom
ENTERTAINMENT:	Sirius XM radio (subscription) Fusion IP700 sound system with speakers in saloon, owner stateroom and flybridge Samsung 32" flat screen LED TV and DVD player in saloon with Bose speaker bar
STATEROOMS:	Two: Owner walk around queen amidships Guest with two stacked berths forward
BEDDING:	(Owner) amidship with large mattress (2) single berths in forward guest stateroom
GALLEY:	Fisher Paykel refrigerator/freezer 3-burner Force 10 stainless steel cooktop and oven (2) propane tanks Miele Optima dishwasher U-line ice maker Whirlpool microwave oven Broan trash compactor
INTERIOR WOOD:	Teak
INTERIOR COUNTERS:	Granite counters
INTERIOR UPHOLSTERY:	Fabric
INTERIOR FLOORING:	Teak and Spruce hardwood solid stock
BILGE PUMPS:	Four: (2) Rule 3700 24V electric high water bilge pump (1) Rule 2000 24V electric bilge pump Whale manual pump
FUEL:	800 gallons 3,028 L (3 fiberglass tanks)
HOLDING BLACK:	50 gallons 189 L (1 fiberglass tank)

Seahorse 52 Paradox II

HEADS:	(2) Tecma electric freshwater heads with macerator
GRAY WATER:	Whale Gulper 24V pump direct discharge NexGen condensate sump pump with float switch Level monitor
FRESH WATER:	300 gallons 1,136 L (2 fiberglass tanks)
FRESH WATER SYSTEM:	(2) Jabsco 24V pumps Dockside inlet Abundant Flow reverse osmosis fresh water for drinking water and icemaker
HOT WATER:	Raritan water heater tank (2021)
SHOWERS:	Three: Owner tub and shower Guest shower stall Cockpit shower
LAUNDRY:	Samsung self-venting combo washer/dryer
WATER MAKER:	Spectra Catalina CT-340Z-24 watermaker - 24V, 16 GPH (2018)
SAFETY:	USCG safety requirements Fireboy engine room fire suppression system Xintex S-2A gas fume detector High water bilge alarm
PHOTO DATE:	Most photos taken April 2021
Note: All information is believed accurate but should be verified.	

Seahorse 52 Paradox II

Layout: Boat Deck and Flybridge

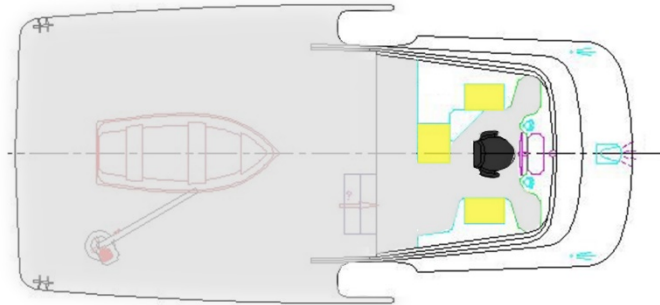

Layout: Main Deck – Saloon, Galley, and Raised Pilothouse

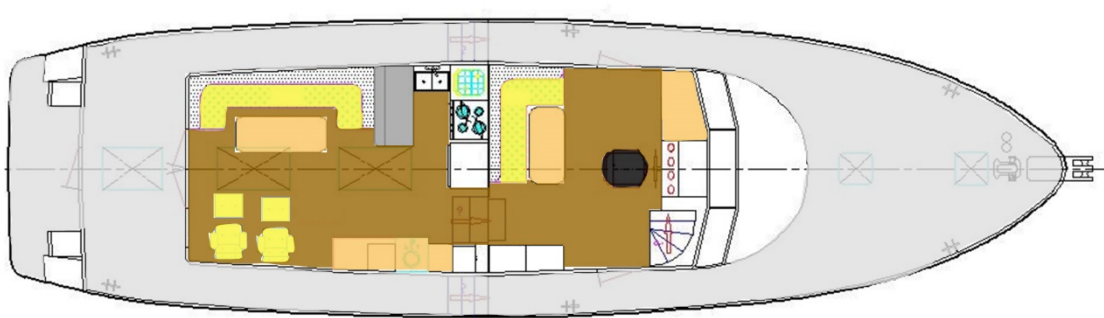

Layout: Lower Deck Staterooms and Heads

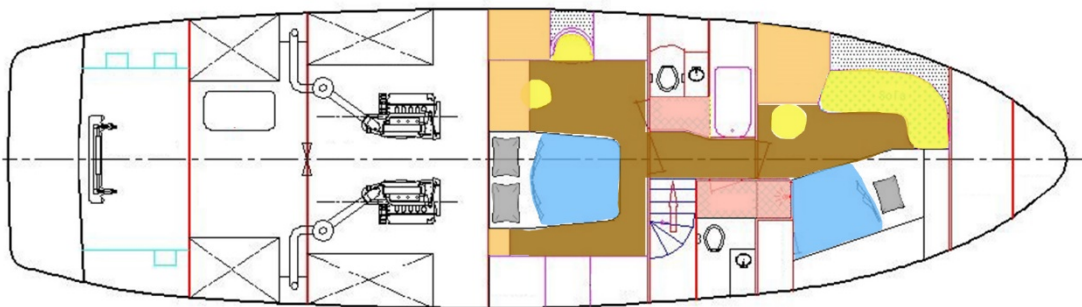

Seahorse 52 Paradox II

ACCOMMODATIONS and LAYOUT: The Seahorse 52 is a full displacement trawler with proven ocean crossing capabilities. The performance aspects have been designed for functionality, utility, and reliability. The interior features finely crafted teak joinery, granite countertops balanced with white laminate inserts with teak and spruce soles. You will appreciate the placement of windows and lighting for visibility as well as hatches, portlights and dorade vents for air circulation. The interior includes air conditioning for climate control. The layout aboard *Paradox II* has a pleasing arrangement that creates a natural transition from one area to the next.

SALOON:

The saloon is entered through a double door aft. Once indoors, you will appreciate the craftsmanship and thought that has gone into this build. The overheads are bright white gelcoat with teak trim that gives a clean accent throughout. The interior soles are primarily teak and spruce. The interior has air conditioning and a diesel furnace for climate control.

There are large windows framing the world outside that provide tremendous views you can enjoy. To port a U-shaped settee surrounds the teak table used for dining. On the starboard side there are two Ekornes lounge chairs that lead up to the flat screen television and then a granite surface atop teak cabinetry. This forward area includes the combination laundry appliance and an icemaker right across from the galley. Window shades add privacy and protect the interior when you are away.

- Double door entry from the cockpit
- U-shape settee to with storage underneath
- Stylish rug over teak and spruce wood floors
- Opening windows with screens
- Samsung flat screen television
- Fusion stereo system with Bose speakers
- Samsung MotoDirecto combination clothes washer and dryer (self-venting)
- U-line ice maker
- SeaVac central vacuum
- Teak dining table
- Glass locker liquor cabinet
- Fan
- Floor access entries for engine room (2 large forward, one smaller aft)
- Fiberglass overhead strakes with teak trim
- Teak and spruce sole
- Windows have screens, pull down blinds and decorative curtains

GALLEY:

Forward to port on the entry level is the galley which has the necessary appliances for preparing meals and a beautiful complement of teak lockers and drawers with granite counters.

- Force 10 (3) burner propane stove and oven
- Stainless steel protective backing behind stove
- Whirlpool microwave and convection oven
- Fisher Paykel stand up refrigerator/freezer with stainless steel face

Jeff Merrill Yacht Sales, Inc. © 2022 All Rights Reserved www.JMYS.com

Seahorse 52 Paradox II

- Broan trash compactor with teak face
- Miele Optima dishwasher
- Stainless steel sink
- Teak and spruce sole
- Opening window
- Overhead storage lockers with louvered doors
- Wine glass slide racks on underside of overhead lockers
- Below counter storage lockers with louvered doors
- Multiple teak storage drawers
- Delta faucet (2020)
- Abundant Flow fresh water tap
- Fan

PILOTHOUSE:

Up a few teak steps brings you to the raised pilothouse. The central command with curved contours and sturdy helm seat is clearly focused and organized for utility and comfort. All navigation and communications as well as operational machinery displays are in clear view and within reach. Behind the helm chair is a built-in settee with table. You can exit to either side deck or continue forward to the lower-level accommodations. Forward to port is a chart surface which lifts for storage. To starboard a teak cabinet with drawers and lockers has a counter top with teak rails for manual bin storage. The electrical panel breakers are located by the aft stairway.

- Gelcoat and fiberglass overhead with teak trim
- Teak and spruce sole
- Windows with a great view in all four directions
- Opening Dutch doors port and starboard
- Contoured helm station with easy access reach to controls
- Settee aft
- Teak table with hinged leaf
- Lighting all around
- Louvered lockers
- Drawers
- Ritchie Powerdamp plus compass
- Custom high-back helm chair
- Teak steering wheel
- Deere engine panels
- MMC engine shift controllers
- Racor vacuum gauge
- Naiad Multitsea II stabilizer control panel
- Side Power bow thruster pad
- Simrad Halo T-O 20" Radar (Radome)
- Simrad GO7SXR 7" display
- Garmin GPS-Map 6212 (soft-key) 12" Multi-Functional Navigation Display
- Garmin GPS-Map 5212 (touchscreen) 12" MFD

Seahorse 52 Paradox II

- Garmin GPS-Map 6208 (soft-key), 8" Display with GPS Chartplotter
- GMR-24 48 Mile HD Marine Radar
- Satellite Weather
- Camera inputs
- GSD-22 Network Sonar
- Garmin AIS-600 (Automatic Identification System) interfaced with MFD's
- Garmin GXM-51 Satellite Marine Weather was interfaced into the MFD's
- CCTV - Engine room camera and stern camera interfaced with the Garmin Multi-Functional Navigation Displays.
- Iridium Satellite Phone
- ICOM IC M-602 VHF radio with loud hailer
- Simrad AP28 autopilot
- Fusion MS IP700 stereo
- Northern Lights generator control panel
- Xantrex inverter/charger control panel
- Xantrex Pathmaker
- Victron Energy battery level monitor
- Muir auto anchor 500C digital chain counter windlass remote
- Spectra water maker remote panel
- Electrical panels with breaker switches
- Remote tank level sensor
- Bilge pump controls
- Wiper control panel
- 12 V outlet
- Level gauge for side-to-side trim
- ITT Jabsco remote controlled Search Light
- Weems & Plath clock
- Weems & Plath barometer
- Fans
- Air conditioning control
- Sirius XM Satellite radio
- Stereo speakers
- Chart table with storage below
- Bell
- Air horn
- Garmin GPS-Map 441 MFD in owner stateroom

LOWER-LEVEL FORWARD: Descending the curved teak stair case forward brings to you to the accommodations deck. The owner cabin is aft, full beam with opening portlights and a fore/aft island bed. There is a dresser and desk to port with hanging lockers and drawers. Forward to port in the master suite is the head, sink and shower with tub. The guest stateroom is up in the bow with two bunks, seating and a desk. There is a private head with shower to starboard in the companionway hallway.

Seahorse 52 Paradox II

OWNER STATEROOM:

For a quiet place to unwind, read, relax and sleep you will be impressed with the owner stateroom arrangement. Located aft on the lower level, down from the stairs connecting to the pilothouse, this is a full beam stateroom with the large bed positioned fore and aft. To starboard a bureau with drawers, to port a desk area and built-in seat. There are opening portlights outboard, good lighting, excellent storage and climate control to make this area comfortable. Richly appointed in teak including louvered door cabinets, plentiful drawers and the desk top. The overhead is white with teak trim and the sole is teak and spruce.

- Large berth facing fore/aft
- Night stands
- Teak and spruce sole
- Vinyl overhead with teak ceilings
- Desk with mirror and swing out seat
- Built in reading seat to port
- Lighting overhead, reading and courtesy
- Book shelves
- Hanging lockers
- Drawer bureau to starboard
- Many drawers
- Opening portlights outboard
- Inverter and batteries under bed
- Garmin GPS Map 441 repeater display

OWNER HEAD:

The owner head is private, accessed from inside the stateroom and positioned forward to port. This convenient area includes a freshwater toilet, sink, mirrored cabinet and shower/tub.

- Tecma fresh water head
- Stand up shower with tub
- Mirror forward of sink
- Granite counter
- Undermount sink with Delta faucet
- Mirrored cabinet above sink
- Storage locker
- Towel racks
- Opening portlight
- Tile floor

Seahorse 52 Paradox II

COMPANIONWAY HEAD:

The lower level is connected by a companionway that begins at the base of the stairs. Moving forward on the starboard side is a convenient head. This is a guest head for all crew and it is not inside either stateroom. Toilet, sink and stand up shower stall.

- Tecma fresh water head
- Stand up shower with door
- Mirror forward of sink
- Granite counter
- Undermount sink with Delta faucet
- Mirrored cabinet above sink
- Opening portlight
- Tile floor

GUEST STATEROOM:

Returning to the companionway, you pass an independent head and shower to starboard before arriving in the guest stateroom forward. This room has an office desk and comfortable a seating area to port. On the starboard side there are two bunk beds. There are opening portlights outboard and a hatch above.

- Two single berths – over/under to starboard
- Built in desk with swing out stool to port
- Curved bench seating area forward to port.
- Louvered locker doors
- Hanging locker
- Drawers
- Book shelves
- Opening portlights outboard
- Opening hatch overhead (with screen)
- Teak and spruce sole

ENGINE ROOM (TWO CHAMBERS):

The engine room is accessed through the saloon floor via two large removeable floor boards forward and a smaller hinged access hatch aft in the saloon to visit the antechamber. The ante chamber has the opening by the saloon entrance and provides the easiest access. The antechamber has the SeaGyro stabilizer aft (disabled), with the Northern Lights generator to starboard. Moving forward you enter the engine room through a hinged door with viewing window There is a deep walking well between the engines and you can also access outboard. If you prefer you can come into the engine room from the forward hatch. The forward hatch open makes it much easier for servicing when at rest as you take away the overhead limits. Twin John Deere engines, fiberglass fuel tanks, a sea chest, fuel manifold, fuel transfer and filtration, Racors, this is a well laid out engine room with important equipment relatively easy to inspect and maintain.

- (2) John Deere 4045TFM75 - 4.5 Liter, Turbocharged - 135 HP engines
- (2) ZF IRM-220-A, 3.0:1 transmissions (starboard refurbished 2021)
- (2) Seal Master thrust bearings with universal joints

Jeff Merrill Yacht Sales, Inc. © 2022 All Rights Reserved www.JMYS.com

Seahorse 52 Paradox II

- (2) PYI PSS dripless shaft seals
- (2) Gulf Coast filters
- Northern Lights 9kW generator
- Naiad active fin stabilizers (2019)
- Sea Gyro stabilization (disabled, replaced with Naiad active fin stabilizers)
- Electric bilge pump
- High water bilge pump
- Spectra water maker
- Fiberglass fuel tanks with sight gauges
- Force 10 hot water tank (disabled, replace with new Raritan in lazarette)
- Starting batteries
- Sea chest with clear viewing top for raw water intake distribution
- Fireboy – fire suppression

LAZARETTE:

The lazarette is under the cockpit aft deck and topped with a large, hinged hatch. This area has the steering gear, air conditioners and the diesel furnace. This is a great storage area for extra supplies and gear.

- Hydraulic steering ram with valves
- Steelhead crane reservoir and control box
- Raised wood floor to level bilge area for moving about
- Dometic air conditioning compressors
- Webasto diesel furnace
- Abundant flow fresh water system
- Raritan hot water tank – 12 gallon
- Northern Lights generator air sep muffler
- Rudder shelf
- PSS rudder shaft gland
- Electric bilge pump with Ultra float switch

EXTERIOR SUMMARY

SWIM PLATFORM/COCKPIT:

On deck you can enjoy swimming aft and relaxing in the cockpit (which has an integrated sink console). *Paradox II* is a widebody so to go forward outside you walk alongside the saloon to starboard A large access hatch provides entry to the lazarette.

- Two built-in storage lockers in swim step
- Stainless steel swim ladder
- Hot and cold-water cockpit shower
- Entrance gate to cockpit from swim step
- Integrated sink with locker port forward of cockpit
- Freeing ports with cleats

Seahorse 52 Paradox II

- Fresh water hose bib
- Stainless steel handrails along gunwhale
- Compression post for crane between boat deck and lazarette
- Large hatch access to lazarette below
- Rod holders
- Double door entry to saloon

FOREDECK:

Forward of the pilothouse and above the guest stateroom. Uncluttered area with deck hatches and high stainless railing. Ground tackle with windlass and deck pipes for rode. Access to the chain locker. A seating area aft with storage lockers outboard.

- Muir HR 2500 Cheetah 24VDC windlass
- Two anchor rollers
- 80 LB. Manson Supreme as primary
- 300' of 3/8" chain
- Danforth secondary
- 100' 3/8" chain and 200' of braided nylon
- Secondary deck pipe
- Fiberglass chain locker access hatch
- Stainless fender holders
- Hawes pipes leading to cleats
- Opening deck hatch for guest cabin
- Molded in seat in front of wheelhouse
- Molded in fiberglass deck boxes aft (outboard of seat)
- Port deck box houses propane tanks, starboard holds secondary rode

BOAT DECK:

Continuing aft along the port side brings you to the boat deck. This deck above the saloon is home to the RIB tender which is launched with a Steelhead crane. The antenna mast can be lowered for passing under bridges.

- 11' Inmar 330R-AL console – aluminum hull (2017)
- Dinghy cover with zipper access
- Tohatsu 20 HP outboard (2017)
- Steelhead ES-1000 crane (2017)
- Rail mounted Magma propane barbeque
- Fiberglass deck storage box

Seahorse 52 Paradox II

FLYBRIDGE:

The view above the pilothouse is spectacular. With a folding Bimini top you have shade in the sun and protection from rain. There is a central command chair with the steering wheel and nav/com instruments forward. Outboard, are molded seats with cushions on top and storage beneath. There is also storage up forward ahead of the helm.

- Bimini overhead
- Single helm chair
- Stainless steel vertical helm steering wheel
- Main engine controls
- Main engine instrument displays
- Stabilizer control panel
- Side Power bow thruster
- Compass
- Search light control pad
- Garmin color multi-function display
- Simrad AP24 autopilot
- ICOM VHF radio
- Fusion stereo and speakers
- Air horn button
- Storage access doors forward
- Large fiberglass built in seating with cushions and storage

SAFETY EQUIPMENT:

- US Coast Guard safety equipment (flares, fire extinguishers, discharge and trash plaques, horn, life jackets, throw ring, etc.)
- Fire-Boy engine room fire system with FE-241 fixed fire suppression in engine room. Automatic thermal and manual activation
- Dual Trumpet 24-volt DC electric air horn
- Ship's Bell mounted in the pilothouse
- One (1) Bilge high water alarm float switch in the engine room and alarms integrated into the other bilge pumps.
- Marine medical kit
- Carbon monoxide detectors
- Smoke detectors
- ITT Jabsco remote controlled Search Light

Construction details: The Seahorse 52 is built in the same hull mold that produced the popular Mandarin 52 cruising sailboat. The hull is a full keel with rounded chines. The shafts have a down angle with four bladed propellers in front of the twin rudders. The hull layup is solid fiberglass mat and woven roving hand laminate atop a gelcoat surface that is then painted with Awlgrip paint for a bright finish. There are glassed in longitudinal stringers in the hull for stiffness. The hull is laid with clear gelcoat and vinyl ester resin below the waterline. The below water surfaces are sealed with an epoxy barrier coat.

Seahorse 52 Paradox II

The interior structure is framed with marine plywood bulkheads glassed in place and bonding the hull and deck. There is an integral swim platform with stainless steel stanchions and a hinged boarding ladder. The deck is cored and painted with Awlgrip.

ADDITIONAL BROKER COMMENTS:

Paradox II is a US Coast Guard Documented vessel. Jeff has been involved in the brokerage sales of several Seahorse 52's, both single and twin-engine versions. The layout flows well and the craftsmanship is at a very high standard. **Paradox II** is loaded and ready to head right back out to sea. The current owners have done an exceptional job looking after her.

A previous owner had a failure with the port engine and had many components replaced. Both engines had their exhaust systems redone to avoid a repeat. Please get in touch for more specifics.

For additional information please visit *Paradox II's* website: www.Seahorse52ForSale.com

Exclusions: Potential purchasers should assume that items on the vessel at the time of viewing, but not specifically listed on this sheet, are not included with the sale of the yacht. These specifications are believed to be true and correct but cannot be guaranteed. Items excluded include, but are not limited to Paintings, tools, handheld nav gear and binoculars. Owner's personal effects and clothing will be removed prior to closing.

Disclaimer: Jeff Merrill Yacht Sales, Inc. presents the details of this vessel in good faith but cannot guarantee or warrant the accuracy of this information nor guarantee or warrant the condition of the vessel. Buyers should instruct their agents and their surveyors to investigate all details the buyers desire validated. This vessel is offered subject to prior sale, price change, or withdrawal without notice.

Brokerage: JMYS is a US based (licensed and bonded yacht brokerage in California, Florida and Washington) with an international emphasis specializing in ocean capable trawlers and recreational tugs. Our brokers are experienced boaters, most are trawler owner/operators with thousands of hours and miles at sea. We treat our clients with respect, we are responsive and not pushy. Our focus is to become your loyal advocate, always looking out for your best interests. The team at JMYS has extensive trawler and motor yacht product knowledge and our skills are available for coaching after the sale has concluded.

Co-Brokerage: Fellow yacht broker association members: **Paradox II** is available for Co-Brokerage. All offers must comply with Florida DPBR regulations. Buyer agents/brokers must be licensed in Florida.

***Listing broker. Jeff Merrill, CPYB** (Certified Professional Yacht Broker) has extensive product knowledge of the trawler market plus direct experience with the Seahorse 52. He has direct contact with Bill Kimley (the owner of Seahorse Marine in China, the builder of these fine boats). Bill is a very personable man and a good resource. Jeff is a familiar face to YouTube viewers and a regular presenter at TrawlerFest. He writes about trawlers for *Ocean Navigator* and *PassageMaker* magazines and is one of the online instructors for *Boaters University*.

Seahorse 52 Paradox II

This listing specification has been approved by the sellers for accuracy. The photos, images and descriptive content are copyrighted by JMYS and may not be copied or used without specific written permission. All inspections are by appointment only. Please contact listing broker, **Jeff Merrill, CPYB** by phone, text or email for additional information or to schedule your personal showing. Jeff is always available via Mobile (949) 355-4950 (call or text). You can send a detailed Email to: Jeff@JMYS.com.



Licensed and Bonded in California, Florida and Washington.

Skype: jeff.merrill | You Tube: Jeff Merrill Yachts | Twitter: @merrillyachts | LinkedIn: jeff.merrill
Facebook: Jeff Merrill Yacht Sales | Instagram: jeffmerrilljmys | Yacht Brokers Association of America |
International Yacht Brokers Association (Florida) | Northwest Yacht Brokers Association |
California Yacht Brokers Association – President 2015 and 2016

